



Valves Technical CTS Quarter-Turn Angle Supply Stop



Features — CPVC

Used at plumbing fixtures to terminate and control hot and cold water, this all-plastic quarter-turn shutoff valve is specially designed for use with CTS (Copper Tube Size) CPVC Hot & Cold Water Distribution Systems. Available in 1/2" CTS Socket or Spears® patented Special Reinforced (SR) 1/2" FIPT female thread inlet x 1/2" NPT, 1/2" compression, 3/8" compression or 1/4" compression male thread outlet for connection to conventional NPT or compression flexible supply line inlet. (See Selection Chart Below.)

- Easy 1/4-Turn Shutoff
- All Plastic Corrosion Proof Construction
- CTS CPVC Tan Colored Body with High Impact Polypropylene Handle
- High Quality EPDM Seals
- NSF® Certified for potable water and lead-free.
- For use in ASTM D 2846 Hot & Cold Water Distribution Systems rated to 100 psi @ 180°F

Sample Engineering Specification

All thermoplastic Angle Supply Stops shall be Copper Tube Size (CTS) sealed unit type constructed from CPVC Type IV, ASTM D 1784 Cell Classification 23447. All O-rings shall be EPDM. All valves shall have Polypropylene handle. All Angle Supply Stops shall be pressure rated at 100 psi for water at 180°F, as manufactured by Spears® Manufacturing Company.

Dimensions

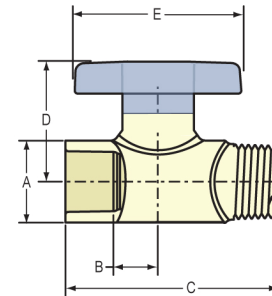
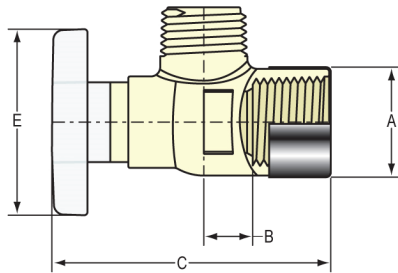
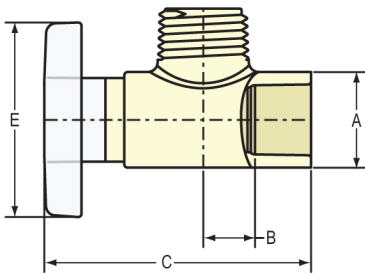

1/4-Turn Angle Supply Stop Socket x NPT/Compression

Nominal Size	A	B	C	E
1/2	7/8	7/16	2-3/8	2
1/2 x 1/4	7/8	1/2	2-5/16	2
1/2 x 3/8	7/8	7/16	2-3/8	2-1/16

1/4-Turn Angle Supply Stop SR FiPT x NPT/Compression

Nominal Size	A	B	C	E
1/2	1-1/32	7/16	2-5/8	2-1/16
1/2 x 3/8	1-1/32	7/16	2-5/8	2-1/16

1/4-Turn Straight Supply Stop Socket x NPT/Compression

Nominal Size	A	B	C	D	E
1/2	7/8	1/2	1-5/32	1-1/4	2
1/2 x 3/8	7/8	1/2	1-1/16	1-1/4	2

Quick-View Valve Selection Chart

Valve Size	Angle Stop Socket x Comp. Thread	Angle Stop Socket x NPT	Angle Stop SR MiPT x Comp. Thread	Angle Stop SR MiPT x NPT	Straight Stop Socket x Comp. Thread	Straight Stop Socket x NPT
1/2 x 1/4	7722CM-072	--	--	--	--	--
1/2 x 3/8	7722-073	--	7721-073SR	--	7422CM-073	--
1/2 x 1/2	7722CM-005	7722-005	--	7721-005SR	7422CM-005	7422-005