



PVC Pipe Flange Dimensions & Information



ENGINEERING GUIDE

Contact Spears® for any Information not found.



The information contained in this publication is based on current information and Product design at the time of publication and is subject to change without notification. Our ongoing commitment to product improvement may result in some variation. No representations, guarantees or warranties of any kind are made as to its accuracy, suitability for particular applications or results to be obtained therefrom. For verification of technical data or additional information not contained herein, please contact Spears® Technical Services Department [West Coast: (818) 364-1611 - East Coast: (678) 985-1263].

GENERAL INFORMATION

Recommendations For Installers And Users

Plastic piping systems should be **ENGINEERED, INSTALLED, and OPERATED** in accordance with **ESTABLISHED DESIGN AND ENGINEERING STANDARDS AND PROCEDURES** For plastic piping systems. Suitability for the intended service application should be determined by the installer and /or user prior to installation of a plastic piping system. **PRIOR TO ASSEMBLY, all piping system components should be inspected for damage or irregularities. Mating components should be checked to assure that tolerances and engagements are compatible. Do not use any components that appear irregular or do not fit properly. Contact the appropriate manufacturer of the component product in question to determine usability.**

Solvent Weld Connections - Use quality solvent cements and primers formulated for the intended service application, pipe size and type of joint. While the pipe and fitting materials may be compatible with the intended medium, the solvent cement may not be. Consult the manufacturer for suitability of use. Read and follow the cement and primer manufacturers' applications and cure time instructions thoroughly. Be sure to use the correct size applicator.

Threaded Connections - Use a quality grade thread sealant. **WARNING: SOME PIPE JOINT COMPOUNDS OR PTFE PASTES MAY CONTAIN SUBSTANCES THAT COULD CAUSE STRESS CRACKING TO PLASTIC.** Spears® Manufacturing Company recommends the use of Spears® **BLUE 75™** thread sealant which has been tested for compatibility with Spears® products. Please follow the sealant manufacturer's application/installation instructions. Choice of an appropriate thread sealant other than those listed above is at the discretion of the installer. 1 to 2 turns beyond **FINGER TIGHT** is generally all that is required to make a sound plastic thread connection. Unnecessary **OVERTIGHTENING** will cause **DAMAGE TO BOTH PIPE AND FITTING.**

"Lead Free" low lead certification - unless otherwise specified; all Spears® Thermoplastic Flanges specified here-in are certified by NSF International to ANSI/NSF® Standard 61, Annex G and is in compliance with California's Health & Safety Code Section 116825 (commonly known as AB1953) and Vermont Act 193. Weighted average lead content $\leq 0.25\%$.





Schedule 80 PVC Technical
PVC Pipe Flange Dimensions & Information

Bolt Kit Selection Guide

Bolt Hardware Kits Available

For Connection of 2-Spears® Flanges

Includes Bolts, Nuts & Flat Washers for Specified Flange Size

Order Gaskets & Bolt Kits Separately

- Pre-coated, Anti-seize Lubricated Bolts
- Available in Zinc Coated Steel, Type 316 Stainless Steel or Type 304 Stainless Steel

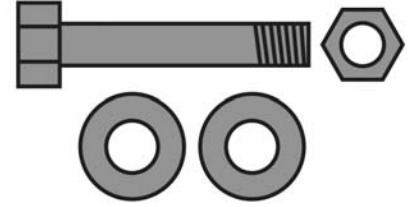

Flange Size	Bolts* Per Kit	Diameter (in.-TPI)	Length (in.)	Zinc	Kit Part Number	
					316 SS	304 SS
1/2	4	1/2 - 13	2	HK-005	HK1-005	HK2-005
3/4 & 1	4	1/2 - 13	2-1/4	HK-010	HK1-010	HK2-010
1-1/4 & 1-1/2	4	1/2 - 13	2-1/2	HK-015	HK1-015	HK2-015
2	4	5/8 - 11	3	HK-020	HK1-020	HK2-020
2-1/2	4	5/8 - 11	3-1/4	HK-025	HK1-025	HK2-025
3	4	5/8 - 11	3-1/2	HK-030	HK1-030	HK2-030
4	8	5/8 - 11	3-1/2	HK-040	HK1-040	HK2-040
5 & 6	8	3/4 - 10	4	HK-060	HK1-060	HK2-060
8	8	3/4 - 10	4-1/2	HK-080	HK1-080	HK2-080
10 & 12	12	7/8 - 9	5	HK-120	HK1-120	HK2-120

* Each Bolt Includes Nut & Two (2) Flat Washers

Bolt Torque

Recommended Bolt Torque is shown in **Table 1**. Threads should be clean and well lubricated. Actual field conditions may require variations in these recommendations. **CAUTION: UNNECESSARY OVER TORQUING WILL DAMAGE THE FLANGE.**

Table 1

Flange Size (in.)	Recommended Torque (ft. lbs.)
1/2 - 1-1/2	12
2 - 4	25
5	30
6 - 8	40
10	64
12	95
14 - 24	110

Torque Sequence

Bolt Torque sequence is shown Below in **Table 2**.

Table 2

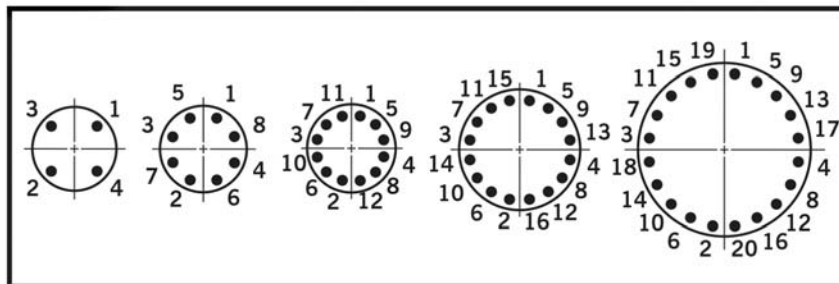

Schedule 80 PVC Technical
PVC Pipe Flange Dimensions & Information



Gaskets

Full faced, 1/8" thick elastomer gaskets with a Shore "A" Durometer of approximately 70 is recommended.

Gasket Selection Guide

Following Gasket Numbers Available from Spears®

Order Gaskets & Bolt Kits Separately

- 1/8" Full-Face design with ANSI Class 150 Bolt Patterns
- Pressure rated to 150 psi @ 73°F
- Available in Buna-N, EPDM, or FKM

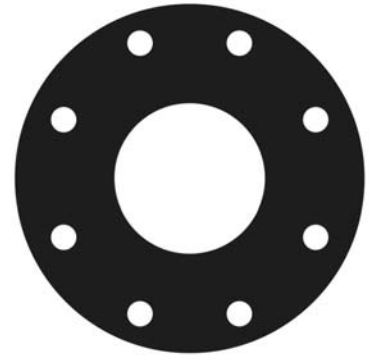

Flange Size	Bolts Per Kit	Gasket Part Number		
		Buna-N	EPDM	FKM
1/2	4	GK1-005	GK2-005	GK3-005
3/4	4	GK1-007	GK2-007	GK3-007
1	4	GK1-010	GK2-010	GK3-010
1-1/4	4	GK1-012	GK2-012	GK3-012
1-1/2	4	GK1-015	GK2-015	GK3-015
2	4	GK1-020	GK2-020	GK3-020
2-1/2	4	GK1-025	GK2-025	GK3-025
3	4	GK1-030	GK2-030	GK3-030
4	8	GK1-040	GK2-040	GK3-040
5	8	GK1-050	GK2-050	GK3-050
6	8	GK1-060	GK2-060	GK3-060
8	8	GK1-080	GK2-080	GK3-080
10	12	GK1-100	GK2-100	GK3-100
12	12	GK1-120	GK2-120	GK3-120

Flange Make-up

Once a flange is joined to pipe, the method for joining two flanges is as follows:

1. Piping runs joined to the flanges must be installed in a straight line position to the flange to avoid stress at the flange due to misalignment. Piping must also be secured and supported to prevent lateral movement which can create stress and damage the flange.
2. With gasket in place, align the bolt holes of the mating flanges by rotating the ring into position.
3. Insert all bolts, washers (two standard flat washers per bolt), and nuts.
4. Make sure the faces of the mating surfaces are flush against gasket prior to bolting down the flanges.
5. Tighten the nuts by hand until they are snug. Establish uniform pressure over the flange face by tightening the bolts in 5 ft.-lbs. increments according to the sequence shown in **Table 2** following a 180° opposing sequence.
6. Care must be taken to avoid "bending" the flange when joining a Spears® flange to a "raised face" flange, or a wafer-style valve. Do not use bolts to bring together improperly mated flanges.

Configuration Terminology

- Multi-Bolt Pattern Ring** - Bolt hole drilling accepts ANSI and Metric Flanges
- Socket** - Slip socket connection for solvent cement welding
- Spigot** - Pipe O.D. connection for solvent welding
- Fipt** - Female Iron Pipe Thread
- SR Fipt** - Spears® patented Special Reinforced (SR) plastic thread
- IPS** - Iron Pipe Size
- PIP** - Plastic Irrigation Pipe



Schedule 80 PVC Technical PVC Pipe Flange Dimensions & Information

Molded Flange Technical Information

Application

Molded CLASS 150 Flange fittings are coupling devices designed for joining IPS (Iron Pipe Size) plastic piping systems, where frequent disassembly may be required, and can be used as a transitional fitting for joining plastic to metal piping systems. Suitability of application is at the discretion of the user.

Pressure Rating

150 psi, water at 73°F.

Flange Types

One Piece - Available in socket configuration, sizes 1/2" through 8"; threaded and SR threaded (Special Reinforced) configuration sizes 1/2" through 4".

Van Stone Style - Two-piece design with rotating flange ring, available in socket configurations, sizes 1/2" through 18"; threaded configurations, sizes 1/2" through 4" and spigot configurations, sizes 1/2" through 12".

Blind - Closed ring design for capping off a mating flange, flanged fitting or flanged valve, available in sizes 1/2" through 12".

Materials

All injection molded flanges are produced from PVC materials approved for potable water use by NSF International (NSF®).

Glass-filled PVC materials may be used in certain Van Stone Style flange rings and large diameter Blind flanges where additional reinforcement is deemed necessary.

Conformance Standards

Socket I.D. & Spigot O.D. - ASTM D 2467 (PVC).

Threads - ASTM F 1498.

Bolt Hole Pattern - ANSI B16.5; ASTM D 4024.

Material - ASTM D 1784 (PVC Cell Classification 12454-B).

Weights & Dimensions

Specified minimum bolt lengths are based on the use of two Spears® Flanges, two standard flat washers, standard nut and 1/8" thick elastomer full face gasket. Mating with other brands or accessories may require variation. Bolts and gaskets are not supplied with flanges.

Dimension references:

L = Overall length of hub, $\pm 1/16$ inch.

M = Outside diameter of socket hub, $\pm 1/16$ inch.

N = (Laying Length) socket/spigot bottom to seal-ring face of flange, $\pm 1/16$ inch.

R = Height (thickness) of flange ring, $\pm 1/16$ inch.

Max O.D. = Outside diameter of ring, $\pm 1/16$ inch.

Bolt Circle Diameter = ANSI B 16.5 Standard; ASTM D 4024, $\pm 1/16$ inch.

Schedule 80 PVC Technical
PVC Pipe Flange Dimensions & Information



Flange One Piece

Socket

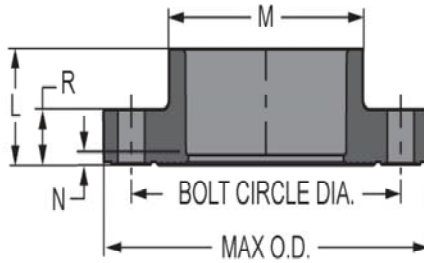

Part Number	Size	L	M	N	R	Bolt Circle Dia.	Bolt Size	Max. O.D.	Min. Bolt Length	No of Bolts	Approx. Wt. (Lbs.)
851-005	1/2	1- 1/16	1- 9/32	1/8	9/16	2- 3/8	1/2	3- 1/2	2	4	.21
851-007	3/4	1- 3/16	1- 1/2	1/8	5/8	2- 3/4	1/2	3- 7/8	2	4	.27
851-010	1	1- 5/16	1-13/16	3/16	3/4	3- 1/8	1/2	4- 1/4	2-1/4	4	.41
851-012	1-1/4	1-3/8	2- 3/16	3/32	21/32	3- 1/2	1/2	4- 5/8	2-1/4	4	.42
851-015	1-1/2	1-19/32	2- 1/2	3/16	23/32	3- 7/8	1/2	5- 1/16	2-1/2	4	.57
851-020	2	1-27/32	3	5/16	27/32	4- 3/4	5/8	6	3	4	.82
851-025	2-1/2	2- 1/4	3- 1/2	1/2	1	5- 1/2	5/8	7	3-1/4	4	1.50
851-030	3	2- 5/16	4- 9/32	3/8	1- 1/16	6	5/8	7- 1/2	3-1/4	4	1.73
851-040	4	2- 7/16	5- 7/32	3/16	1- 5/32	7- 1/2	5/8	9- 1/16	3-1/2	8	2.67
851-050	5	3- 1/4	6- 3/8	1/4	1	8- 1/2	3/4	10- 1/8	3-1/4	8	2.99
851-060	6	3- 1/4	7- 9/16	1/4	1- 3/8	9- 1/2	3/4	11	4	8	4.05
851-080	8	4-17/32	9- 3/4	1/2	1- 7/16	11-3/4	3/4	13- 5/8	4-1/2	8	7.63
851-100	10	5-3/8	11-25/32	13/32	1-21/32	14-1/4	7/8	16	4	12	12.94
851-100F*	10	9-7/8	11-15/16	4- 5/8	1- 3/8	14- 1/4	7/8	16	4	12	18.88
851-120	12	6-7/16	13-15/16	1/2	1-11/16	17	7/8	19	5	12	12.74
851-120F*	12	10-11/16	14- 1/8	4-7/16	1-3/8	17	7/8	19	5	12	26.90
851-140F*	14	7-9/16	15-9/16	9/16	2	18-3/4	1	21	5-1/2		26.83
851-160F*	16	8-9/16	17-3/4	9/16	2-3/8	21-1/4	1	23-1/2	6-1/2	16	39.00
851-180F*	18	15	19-1/8	6	1-1/2	22-3/4	1-1/2	25	4-1/8	16	45.81
851-200F*	20	16	21-3/16	6	1-1/2	25	1-1/8	27-1/2	5-1/2	20	57.81
851-240F*	24	19	25-3/8	7	1-1/2	29-1/2	1-1/4	32	5-1/2	20	84.58

* Fabricated

Flange One Piece

Flt

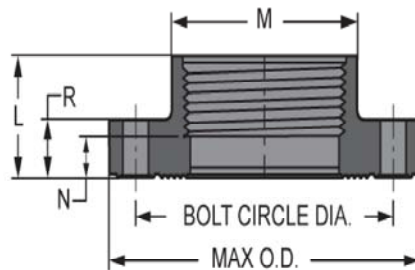

Part Number	Size	L	M	N	R	Bolt Circle Dia.	Bolt Size	Max. O.D.	No of Bolts	Approx. Wt. (Lbs.)
852-005	1/2	1- 1/16	1- 5/16	9/32	9/16	2- 3/8	1/2	3- 1/2	4	.20
852-007	3/4	1- 3/16	1-17/32	15/32	5/8	2- 3/4	1/2	3- 7/8	4	.29
852-010	1	1- 5/16	1-13/16	7/16	3/4	3- 1/8	1/2	4- 1/4	4	.40
852-012	1-1/4	1- 3/8	2- 7/32	17/32	23/32	3- 1/2	1/2	4- 5/8	4	.43
852-015	1-1/2	1-11/16	2- 1/2	19/32	23/32	3-27/32	1/2	5- 1/16	4	.61
852-020	2	1-27/32	3	7/8	7/8	4- 3/4	5/8	6	4	.95
852-025	2-1/2	2- 1/4	3- 1/2	15/16	1	5- 1/2	5/8	7	4	1.57
852-030	3	2- 5/16	4- 9/32	29/32	1- 1/16	6	5/8	7- 1/2	4	1.82



Schedule 80 PVC Technical
PVC Pipe Flange Dimensions & Information

Flange One Piece

Fipt

(Continued)

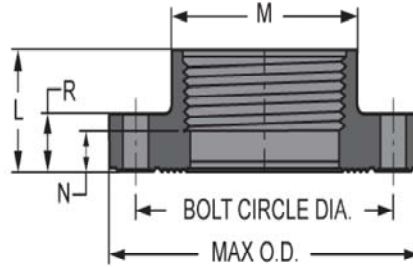

Part Number	Size	L	M	N	R	Bolt Circle Dia.	Bolt Size	Max. O.D.	No of Bolts	Approx. Wt. (Lbs.)
852-040	4	2- 1/16	5-3/16	5/16	1- 1/4	7- 1/2	5/8	9	8	2.91
852-060F*	6	6-11/16	7-3/16	5-3/16	1- 5/16	9- 1/2	3/4	11	8	7.98
852-080F*	8	8- 3/8	9- 5/16	6-5/8	1- 7/16	11- 3/4	3/4	13-5/8	8	13.92

* Fabricated

Flange - Special Reinforced One Piece

SR Fipt

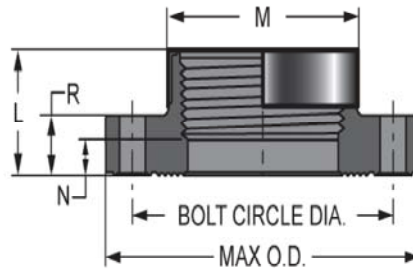

Part Number	Size	L	M	N	R	Bolt Circle Dia.	Bolt Size	Max. O.D.	No of Bolts	Approx. Wt. (Lbs.)
852-005SR	1/2	1- 3/32	1- 7/32	11/32	9/16	2- 3/8	1/2	3- 1/2	4	.20
852-007SR	3/4	1- 3/16	1- 3/8	7/16	5/8	2- 3/4	1/2	3- 7/8	4	.27
852-010SR	1	1- 7/16	1-23/32	17/32	21/32	3- 1/8	1/2	4- 1/4	4	.38
852-012SR	1-1/4	1- 9/16	2- 1/16	19/32	21/32	3- 1/2	1/2	4- 5/8	4	.49
852-015SR	1-1/2	1- 3/4	2- 7/16	3/4	3/4	3- 7/8	1/2	5	4	.64
852-020SR	2	1-13/16	3- 1/32	13/16	13/16	4- 3/4	5/8	5-31/32	4	.99
852-025SR	2-1/2	2- 1/8	3-19/32	3/8	1	5- 1/2	5/8	7	4	1.58
852-030SR	3	2- 5/16	4- 9/32	27/32	1- 1/16	6	5/8	7- 1/2	4	1.89
852-040SR	4	2- 1/2	5-3/16	1	1- 5/32	7- 1/2	5/8	9	8	3.00

Flange - Blind

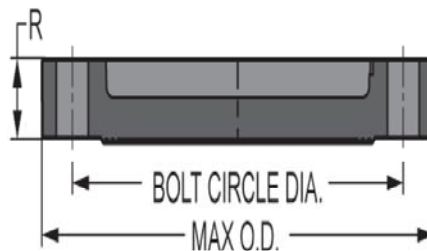

Part Number	Size	R	Bolt Circle Dia.	Bolt Size	Max. O.D.	Min. Bolt Length	No of Bolts	Approx. Wt. (Lbs.)
853-005	1/2	17/32	2- 3/8	1/2	3-17/32	2	4	.20
853-007	3/4	5/8	2- 3/4	1/2	3- 7/8	2	4	.28
853-010	1	3/4	3- 1/8	1/2	4- 1/4	2-1/4	4	.40
853-012	1-1/4	23/32	3- 1/2	1/2	4- 5/8	2-1/4	4	.37
853-015	1-1/2	23/32	3-27/32	1/2	5- 1/16	2-1/2	4	.49

Schedule 80 PVC Technical
PVC Pipe Flange Dimensions & Information



Flange - Blind

(Continued)

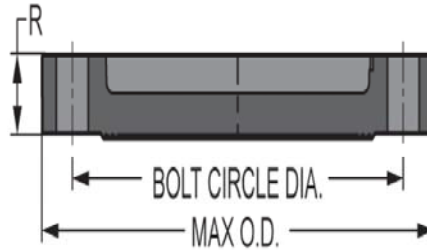

Part Number	Size	R	Bolt Circle Dia.	Bolt Size	Max. O.D.	Min. Bolt Length	No of Bolts	Approx. Wt. (Lbs.)
853-020	2	27/32	4- 3/4	5/8	5-31/32	3	4	.81
853-025	2-1/2	1	5- 1/2	5/8	7	3-1/4	4	1.52
853-030	3	1- 1/16	6	5/8	7- 1/2	3-1/4	4	1.64
853-040	4	1- 5/32	7- 1/2	5/8	9- 1/16	3-1/2	8	2.41
853-060	6	1- 3/8	9- 1/2	3/4	11	4	8	4.36
853-080	8	1- 7/16	11- 3/4	3/4	13- 1/2	4-1/2	8	6.74
853-100	10	1-11/16	14- 1/4	7/8	16	5	12	11.67
853-120	12	1-11/16	17	7/8	19	5	12	16.96

**Flange Van Stone Style IPS
 (With Plastic Ring)**

Socket

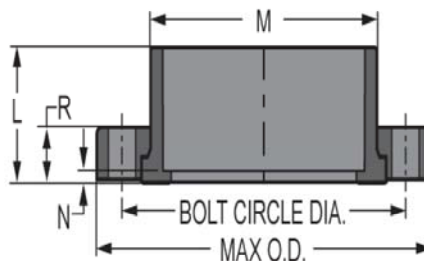

Part Number	Size	L	M	N	R	Bolt Circle Dia.	Bolt Size	Max. O.D.	No of Bolts	Approx. Wt. (Lbs.)
854-005	1/2	1- 1/32	1- 7/32	5/32	17/32	2- 3/8	1/2	3- 1/2	4	.18
854-007	3/4	1- 1/8	1- 7/16	5/32	9/16	2- 3/4	1/2	3- 7/8	4	.25
854-010	1	1- 9/32	1- 3/4	5/32	5/8	3- 1/8	1/2	4- 1/4	4	.35
854-012	1-1/4	1-13/32	2- 5/32	5/32	11/16	3- 1/2	1/2	4- 5/8	4	.43
854-015	1-1/2	1-17/32	2- 7/16	3/16	3/4	3- 7/8	1/2	5	4	.55
854-020	2	1-11/16	2-15/16	3/16	13/16	4- 3/4	5/8	6	4	.85
854-025	2-1/2	2	3- 1/2	3/16	31/32	5- 1/2	5/8	7	4	1.42
854-030	3	2- 1/8	4- 1/4	1/4	1- 1/16	6	5/8	7- 1/2	4	1.78
854-040	4	2- 1/2	5- 1/4	1/4	1- 1/8	7- 1/2	5/8	9	8	2.76
854-050	5	3	6- 1/4	3/8	1- 1/8	8- 1/2	3/4	10- 1/8	8	3.29
854-060	6	3- 3/8	7- 9/16	7/16	1- 9/32	9- 1/2	3/4	11	8	4.69
854-080	8	4- 3/8	9- 5/16	9/32	1-3/8	11- 3/4	3/4	13- 1/2	8	6.75
854-100	10	5-11/16	11- 3/4	21/32	1- 5/8	14- 1/4	7/8	16	12	11.68
854-120	12	7- 1/4	13- 3/4	5/8	1-5/8	17	7/8	19	12	17.30
854-140	14	7- 1/2	15- 1/2	1/2	2	18- 3/4	1	21	12	27.37
854-160	16	8- 3/4	17- 3/4	1/2	2- 3/8	21- 1/4	1	23- 1/2	16	40.07
854-180	18	9	20	1/4	2- 3/8	22- 3/4	1- 1/8	25	16	45.97



Schedule 80 PVC Technical
PVC Pipe Flange Dimensions & Information

**Flange Van Stone Style
 (Two Piece)**

Socket

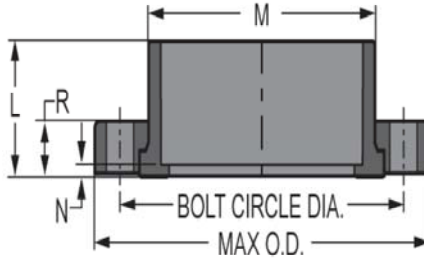

Part Number	Size	L	M	N	R	Bolt Circle Dia.	Bolt Size	Max. O.D.	No of Bolts	Approx. Wt. (Lbs.)
S854-020	2	1-11/16	2-15/16	3/16	13/16	4- 3/4	5/8	6	4	.96
S854-030	3	2- 1/8	4- 1/4	1/4	1- 1/16	6	5/8	7- 1/2	4	1.95
S854-040	4	2- 1/2	5- 1/4	1/4	1- 1/8	7- 1/2	5/8	9	8	2.30
S854-060	6	3- 3/8	7- 9/16	7/16	1- 9/32	9- 1/2	3/4	11	8	5.05
S854-080	8	4- 3/8	9- 5/16	3/8	1- 3/8	11- 3/4	3/4	13- 1/2	8	6.01
S854-100	10	5-11/16	11- 3/4	11/16	1- 5/8	14- 1/4	7/8	16	12	11.56
S854-120	12	7- 1/4	13- 3/4	5/8	1- 3/4	17	7/8	19	12	15.95

**Flange Van Stone Style
 with Multi-Bold Pattern Ring
 (Two Piece)**

Socket

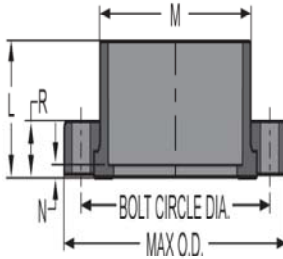

Part Number	Size	L	M	N	R	Bolt Circle Dia Max	Bolt Circle Dia Min	Bolt Size	Max. O.D.	No of Bolts	Approx. Wt. (Lbs.)
M854-020	2	1-11/16	2-15/16	3/16	13/16	4-15/16	4- 1/2	5/8	6	4	.85
M854-060	6	3- 3/8	7- 9/16	7/16	1- 9/32	9-1/2	9-7/32	3/4	11	8	4.61
M854-080	8	4- 3/8	9- 5/16	3/8	1- 3/8	11-3/4	11- 1/2	3/4	13- 1/2	8	6.90

**Flange Van Stone Style
 (Two Piece)**

Fipt

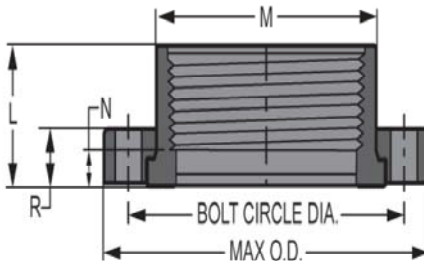

Part Number	Size	L	M	N	R	Bolt Circle Dia.	Bolt Size	Max. O.D.	No of Bolts	Approx. Wt. (Lbs.)
855-005	1/2	1- 1/32	1- 7/32	9/32	17/32	2- 3/8	1/2	3- 1/2	4	.19
855-007	3/4	1- 5/32	1- 3/8	13/32	9/16	2- 3/4	1/2	3- 7/8	4	.27
855-010	1	1- 1/4	1- 3/4	5/16	5/8	3- 1/8	1/2	4- 1/4	4	.36
855-012	1-1/4	1- 3/8	2- 1/8	13/32	11/16	3- 1/2	1/2	4- 5/8	4	.44
855-015	1-1/2	1-15/32	2- 7/16	13/32	3/4	3- 7/8	1/2	5	4	.55
855-020	2	1- 9/16	2-31/32	1/2	13/16	4- 3/4	5/8	6	4	.87
855-025	2-1/2	2	3- 9/16	7/16	1	5- 1/2	5/8	7	4	1.48
855-030	3	2- 1/8	4- 1/4	1/2	1- 1/16	6	5/8	7- 1/2	4	1.83

Schedule 80 PVC Technical
PVC Pipe Flange Dimensions & Information



**Flange Van Stone Style
 (Two Piece)**

Fipt

(Continued)

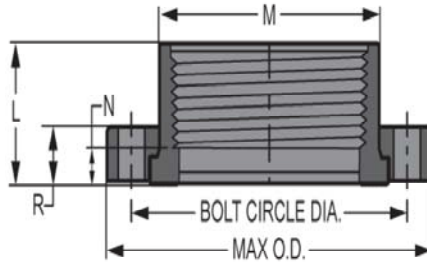

Part Number	Size	L	M	N	R	Bolt Circle Dia.	Bolt Size	Max. O.D.	No of Bolts	Approx. Wt. (Lbs.)
855-040	4	2- 1/16	5- 1/4	3/8	1- 1/4	7- 1/2	5/8	9	8	2.70
855-060F*	6	6-13/16	7- 3/16	5-5/16	1- 1/4	9- 1/2	3/4	11-3/16	8	7.62
855-080F*	8	8- 1/8	9- 5/16	6- 7/16	1- 1/2	11- 3/4	3/4	13- 1/2	8	11.30
855-100F*	10	10- 3/8	11- 9/16	8-1/2	1-11/16	14- 1/4	7/8	16	12	21.49
855-120F*	12	11-7/8	13-3/4	9-3/4	1-11/16	17	7/8	19	12	33.23

* Fabricated

**Flange Van Stone Style
 (Two Piece)**

Spigot

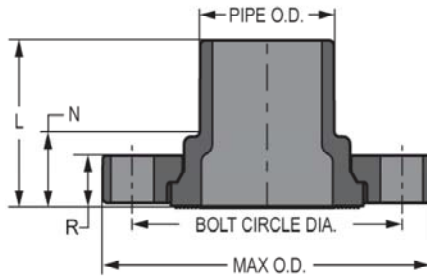

Part Number	Size	L	N	R	Bolt Circle Dia.	Bolt Size	Max. O.D.	No of Bolts	Approx. Wt. (Lbs.)
856-005	1/2	1- 3/4	29/32	17/32	2- 3/8	1/2	3- 1/2	4	.20
856-007	3/4	1-15/16	31/32	9/16	2- 3/4	1/2	3- 7/8	4	.28
856-010	1	2- 3/16	1- 1/32	5/8	3- 1/8	1/2	4- 1/4	4	.38
856-012	1-1/4	2-11/32	1- 3/32	11/16	3- 1/2	1/2	4- 5/8	4	.47
856-015	1-1/2	2- 5/8	1- 9/32	3/4	3- 7/8	1/2	5	4	.60
856-020	2	2- 7/8	1-11/32	13/16	4- 3/4	5/8	6	4	.93
856-025	2-1/2	3- 1/16	1- 9/32	1	5- 1/2	5/8	7	4	1.55
856-030	3	3- 3/8	1- 7/16	1- 1/16	6	5/8	7- 1/2	4	1.93
856-040	4	3- 7/8	1- 5/8	1- 1/4	7- 1/2	5/8	9	8	3.01
856-060	6	4- 3/4	1-25/32	1- 9/32	9- 1/2	3/4	11	8	4.76
856-080	8	5- 7/8	1-15/16	1- 3/8	11- 3/4	3/4	13- 1/2	8	7.67
856-100	10	8	2- 1/4	1- 5/8	14- 1/4	7/8	16	12	15.61
856-120	12	8- 1/2	2- 3/16	1- 5/8	17	7/8	19	12	22.66



Schedule 80 PVC Technical
PVC Pipe Flange Dimensions & Information

**Flange Van Stone Style
 with Multi-Bolt Pattern Ring
 (Two Piece)**

Spigot

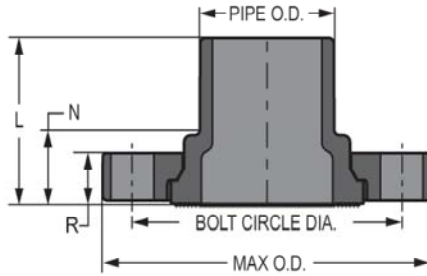

Part Number	Size	L	N	R	Bolt Circle Dia.	Bolt Size	Max. O.D.	No of Bolts	Approx. Wt. (Lbs.)
M856-020	2	2- 7/8	1-11/32	13/16	4- 1/2	5/8	6	4	.94
M856-060	6	4- 3/4	1-25/32	1- 9/32	9- 7/32	3/4	11	8	4.69
M856-080	8	5- 7/8	1-15/16	1- 3/8	11- 1/2	3/4	13- 1/2	8	7.82





Fabricated Flange Technical Information

Application

Fabricated IPS and PIP Flange fittings are coupling devices designed for joining IPS (Iron Pipe Size) or PIP (Plastic Irrigation Pipe) plastic piping systems, where frequent disassembly may be required. These flanges can be used as transitional fittings for joining IPS-to-IPS, PIP-to-PIP, IPS-to-PIP, or plastic to metal piping systems. Suitability of application is at the discretion of the user.

Pressure Rating

All standard fabricated flanges are Van Stone Style (except blind flange) - two piece design with rotating flange ring.

Class 150 IPS Flanges (with steel ring): 150 psi, water at 73°F.

IPS Flanges 18" - 24" (with plastic ring): 50 psi, water at 73°F.

IPS Flanges, Class 300 Bolt Pattern (with plastic ring): 1/2" - 16" 150 psi, 18" - 24" 50 psi, water at 73°F.

Blind Flanges, 14" - 24": 50 psi, water at 73°F.

PIP Flanges, 6" - 16" (with plastic ring & molded IPS flanges w/PIP Adapters): 125 psi, water at 73°F

PIP Flanges, 18" - 24" (with steel ring): 125 psi, water at 73°F

Flange Types

Van Stone Style Class 150 IPS (with steel ring) - Fabricated PVC body with steel flange ring, available in sizes 18" through 24", slip socket and 14" through 24", spigot.

Van Stone Style IPS (with plastic ring) - Fabricated PVC body with PVC flange ring, available in sizes 18" through 24", slip socket and 14" through 24", spigot.

Van Stone Style PIP (with plastic ring) - PIP adapter fabricated to injection molded PVC Van Stone Style IPS flange, available in sizes 6" through 16", slip socket.

Van Stone Style PIP (with steel ring) - Fabricated PVC body with steel flange ring, available in sizes 14" through 24", slip socket.

Blind - Closed ring design for capping off a mating flange; fabricated PVC available in sizes 5" and 14" through 24".

Special Note On PIP Flange Sizes

In order to facilitate connections between IPS and PIP systems, all Plastic Irrigation Pipe flanges are fabricated with PIP sockets using standard IPS Flange Rings. These are indicated in dimension tables under "Size" as (nominal IPS flange size) x (actual PIP O.D.), such as: 6" x 6.140".

To better meet user needs, Spears® offers flanges for 15.300" O.D. PIP with either 14" or 16" IPS Flange Rings. In addition, both 18.360" and 18.701" O.D. PIP are offered with 18" IPS Flange Rings.

Materials

All fabricated flanges are produced from PVC materials approved for potable water use by the National Sanitation Foundation (NSF®). Steel flange rings are carbon steel.

Conformance Standards

Materials - ASTM D 1784 (PVC Cell Classification 12454-B).



Schedule 80 PVC Technical
PVC Pipe Flange Dimensions & Information

Weights & Dimensions

Specified minimum bolt lengths are based on the use of two Spears® Flanges, two standard flat washers, standard nut and 1/8" thick elastomer full face gasket. Mating with other brands or accessories may require variations.

Note: Bolts and gaskets are not supplied with flanges.

Dimension references:

- L** = Overall length of hub, ± 1/2 inch.
- M** = Outside diameter of socket hub, ± 1/4 inch.
- N** = (Laying Length) socket bottom to seal-ring face of flange, ± 1/2 inch.
- R** = Height (thickness) of flange ring, ± 1/16 inch.

Max O.D. = Outside diameter of ring, ± 1/16 inch.

Bolt Circle Diameter = ANSI B 16.5 Standard; ASTM D 4024, ± 1/16 inch.

**Flange Van Stone Style PIP
 (With Plastic Ring)**

Socket

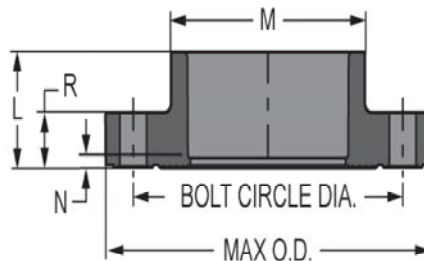

Part Number	Size	L	M	N	R	Bolt Circle Dia.	Bolt Size	Max. O.D.	No of Bolts	Approx. Wt. (Lbs.)
354-060F*	6X6.140	4-1/16	7- 9/16	11/16	1- 1/4	9- 1/2	3/4	11-1/4	8	5.62
354-080F*	8X8.160	4-15/16	9- 3/8	9/16	1- 1/2	11- 3/4	3/4	13- 5/8	8	8.19
354-100F*	10X10.200	6- 1/4	11- 3/4	1	1-11/16	14- 1/4	7/8	16	12	14.21
354-120F*	12X12.240	7-3/8	13-11/16	1-1/8	1-11/16	17	7/8	19	12	20.91
354-151F*	16X15.300	8-11/16	17- 3/4	11/16	2- 3/8	21- 1/4	1	23- 1/2	16	47.23

* Fabricated

**Flange Van Stone Style PIP
 (With Plastic Ring)**

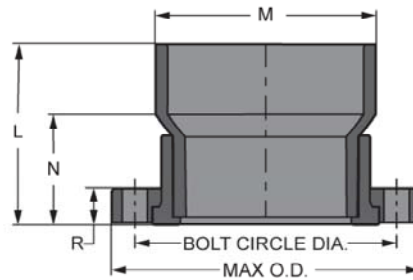

Part Number	Size	L	M	N	R	Bolt Circle Dia.	Bolt Size	Max. O.D.	No of Bolts	Approx. Wt. (Lbs.)
354-150F*	14X15.300	18-5/16	16- 3/16	10- 5/16	2	18- 3/4	1	21	12	46.53

* Fabricated

Schedule 80 PVC Technical
PVC Pipe Flange Dimensions & Information



**Flange Van Stone Style PIP
 (With Steel Ring)**

Socket

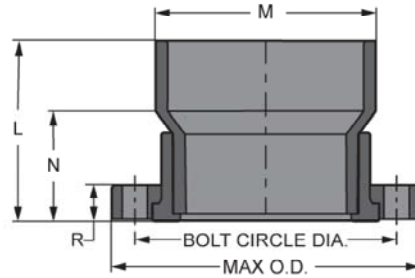

Part Number	Size	L	M	N	R	Bolt Circle Dia.	Bolt Size	Max. O.D.	No of Bolts	Approx. Wt. (Lbs.)
354-181F*	18X18.701	15- 1/8	19-13/16	6- 1/8	1/2	22- 3/4	1-1/4	25	16	53.79
354-182F*	18X18.360	11- 5/8	19- 1/2	5- 5/8	1/2	22- 3/4	1-1/4	25	16	46.62
354-201F*	20X22.047	16- 9/16	23- 1/4	6- 9/16	1/2	25	1-1/4	27- 1/2	20	64.42
354-241F*	24X24.803	19- 7/8	26- 3/16	7- 7/8	1/2	29- 1/2	1- 1/4	32	20	101.10

* Fabricated

Flange - Blind

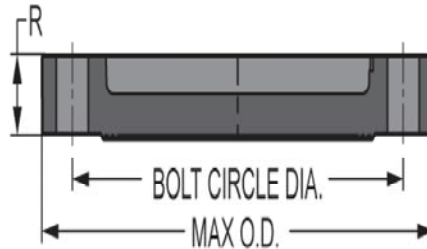

Part Number	Size	R	Bolt Circle Dia.	Bolt Size	Max. O.D.	Min. Bolt Length	No of Bolts	Approx. Wt. (Lbs.)
853-050F*	5	1	8- 1/2	3/4	10- 1/16	4-1/8	8	5.06
853-140F*	14	1- 1/2	18- 3/4	1	21	4-1/8	12	34.00
853-160F*	16	1- 1/2	21- 1/4	1	23- 1/2	4-1/8	16	32.00
853-180F*	18	1- 1/2	22- 3/4	1- 1/8	25	4-1/8	16	36.69
853-200F*	20	1- 1/2	25	1- 1/8	27- 1/2	4-1/8	20	45.00
853-240F*	24	1- 1/2	29- 1/2	1- 1/4	32	5-1/2	20	65.19

**Flange Van Stone Style IPS
 (With Plastic Ring)**

Socket

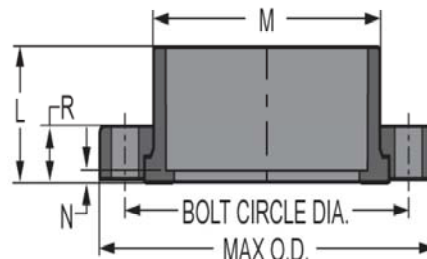

Part Number	Size	L	M	N	R	Bolt Circle Dia.	Bolt Size	Max. O.D.	No of Bolts	Approx. Wt. (Lbs.)
854-180FP*	18	15	19- 1/8	6	1- 1/2	22- 3/4	1- 1/8	25	16	39.75
854-200FP*	20	16	21- 3/16	6	1- 1/2	25	1- 1/8	27- 1/2	20	55.08
854-240FP*	24	19	25- 3/8	7	1- 1/2	29- 1/2	1- 1/4	32	20	80.92



Schedule 80 PVC Technical
PVC Pipe Flange Dimensions & Information

**Flange Van Stone Style IPS
 (With Steel Ring)**

Socket

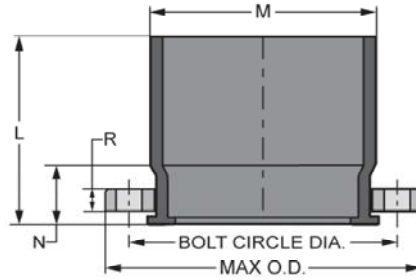

Part Number	Size	L	M	N	R	Bolt Circle Dia.	Bolt Size	Max. O.D.	No of Bolts	Approx. Wt. (Lbs.)
854-120FS*	12	9-5/8	13-9/16	3-3/8	1/2	17	7/8	19	12	28.34
854-140FS*	14	11	14-7/8	4	1/2	18-3/4	1	21	12	36.96
854-160FS*	16	13-1/2	17	5-1/2	1/2	21-1/4	1	23-1/2	16	52.11
854-180FS*	18	14	19- 1/8	5	1/2	22- 3/4	1- 1/8	25	16	54.18
854-200FS*	20	15	21- 3/16	5	1/2	25	1- 1/8	27- 9/16	20	65.00
854-240FS*	24	18	25- 3/8	6	1/2	29- 1/2	1- 1/4	32	20	96.36

* Fabricated

**Flange Van Stone Style Class
 300
 (With Plastic Ring)**

Socket

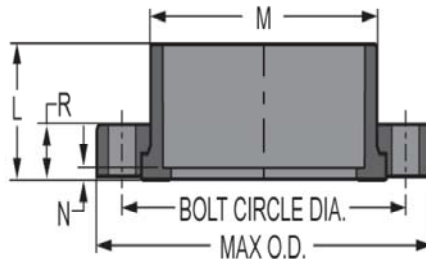

Part Number	Size	L	M	N	R	Bolt Circle Dia.	Bolt Size	Max. O.D.	No of Bolts	Approx. Wt. (Lbs.)
854-005CL300*	1/2	1	1- 3/16	3/16	1/2	2- 5/8	1/2	3- 3/4	4	.45
854-007CL300*	3/4	1- 1/8	1- 3/8	3/16	1	3- 1/4	5/8	4- 5/8	4	.85
854-010CL300*	1	1- 1/4	1- 3/4	3/16	1	3- 1/2	5/8	4- 7/8	4	2.68
854-012CL300*	1-1/4	1- 3/8	2- 1/8	1/8	1	3- 7/8	5/8	5- 1/4	4	1.69
854-015CL300*	1-1/2	1- 1/2	2- 7/16	3/16	1	4- 1/2	5/8	6- 1/8	4	2.40
854-020CL300*	2	1-11/16	2-15/16	3/16	1	5	5/8	6- 1/2	8	1.12
854-025CL300*	2-1/2	2	3- 9/16	1/4	1	5- 7/8	3/4	7- 1/2	8	1.80
854-030CL300*	3	2- 1/8	4- 1/4	1/4	1	6- 5/8	3/4	8- 1/4	8	2.26
854-040CL300*	4	2- 1/2	5- 1/4	1/4	1- 1/2	7- 7/8	3/4	10	8	8.63
854-060CL300*	6	3- 7/16	7- 9/16	3/8	1- 1/2	10- 5/8	3/4	12- 1/2	12	13.85
854-080CL300*	8	4- 3/8	9- 3/8	5/16	1- 1/2	13	7/8	15	12	10.24
854-100CL300*	10	5-11/16	11- 3/4	5/8	1- 1/2	15- 1/4	1	17- 1/2	16	18.19
854-120CL300*	12	6-5/8	13-11/16	5/8	1- 1/2	17- 3/4	1- 1/8	20- 1/2	16	19.50
854-140CL300*	14	7- 9/16	15- 9/16	9/16	2	20- 1/4	1- 1/8	23	20	49.98
854-160CL300*	16	8- 9/16	17- 3/4	9/16	2	22- 1/2	1- 1/4	25- 1/2	20	66.57

* Fabricated

Schedule 80 PVC Technical
PVC Pipe Flange Dimensions & Information



**Flange Van Stone Style Class 300
 (With Plastic Ring)**

Socket

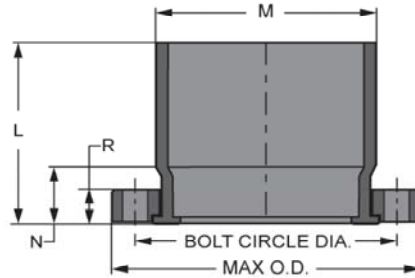

Part Number	Size	L	M	N	R	Bolt Circle Dia.	Bolt Size	Max. O.D.	No of Bolts	Approx. Wt. (Lbs.)
854-180CL300*	18	15	19- 1/8	6	2	24- 3/4	1- 1/4	28	24	61.10
854-200CL300*	20	15- 1/4	21- 3/16	5- 1/4	2	27	1- 1/4	30- 1/2	24	104.07
854-240CL300*	24	19	25- 3/8	7	2	32	1- 1/2	36	24	109.80

* Fabricated

**Flange Van Stone Style
 (Two Piece)**

Spigot

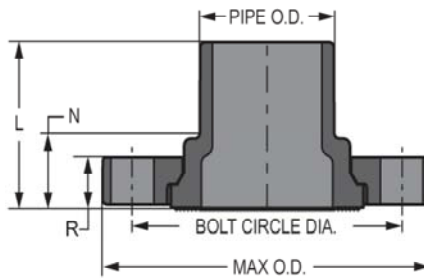

Part Number	Size	L	N	R	Bolt Circle Dia.	Bolt Size	Max. O.D.	No of Bolts	Approx. Wt. (Lbs.)
856-140FP*	14	15- 5/16	7-9/16	2	18- 3/4	1	21	12	41.85
856-160FP*	16	17-13/16	8- 9/16	2- 3/8	21- 1/4	1	23- 1/2	16	61.81
856-180FP*	18	19- 9/16	9-1/2	2- 3/8	22- 3/4	1- 1/8	25	16	77.97
856-200FP*	20	13	2- 1/16	1- 1/2	25	1- 1/8	27- 1/2	20	51.07
856-240FP*	24	16- 3/8	2-3/16	1- 1/2	29- 1/2	1- 1/4	32	20	68.00

**Flange Van Stone Style IPS
 (with Steel Ring)**

Spigot

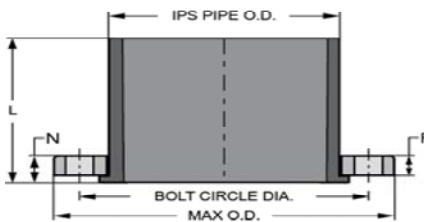

Part Number	Size	L	N	R	Bolt Circle Dia.	Bolt Size	Max. O.D.	No of Bolts	Approx. Wt. (Lbs.)
856-140FS*	14	10	15/16	1/2	18- 3/4	1	21	12	35.13
856-160FS*	16	11	1	1/2	21- 1/4	1	23- 1/2	16	46.50
856-180FS*	18	12	1- 1/16	1/2	22- 3/4	1- 1/8	25	16	47.26
856-200FS*	20	13	1- 1/16	1/2	25	1- 1/8	27- 1/2	20	59.00
856-240FS*	24	15- 3/8	1-3/16	1/2	29- 1/2	1- 1/4	32	20	84.00

* Fabricated