



**Turf Swivel Kits**

**3-Elb Swivel Joint Kits**

Complete kit for field assembly with any length of user supplied pipe. Kit includes upper and lower Elbow assemblies with choice of the following Inlet & Outlet Options:

Inlet Code:  
 1 = Socket  
 2 = Spigot  
 3 = Mipt

Outlet Code:  
 1= Socket  
 2= Mipt  
 4 = Fipt

**Outlet Style**

To complete part no., specify:  
 Inlet style: 1, 2 or 3  
 Outlet style: 1, 2 or 4

Example: To order a 1/2" Turf Swivel Joint Kit with a Spigot inlet and an FIPT outlet, the part number is: ST524-100

**Turf Swivel Joint Kit**

Part Number	Size	Std Pk	Mstr Ctn	Prod Code	MSRP
<b>3-Elb Swivel Joint Kits</b>					
ST5__-100	1/2	10	0	030	22.87
ST7__-100	3/4	10	0	030	25.83
ST9__-100	1	10	0	030	30.06

**4-Elb Swivel Joint Kits**

Complete kit for field assembly with any length of user supplied pipe. Kit includes upper and lower Elbow assemblies with choice of the following Inlet & Outlet Options:

Inlet Code:  
 1 = Socket  
 2 = Spigot  
 3 = Mipt

Outlet Code:  
 1= Socket  
 2= Mipt  
 4 = Fipt

**Outlet Style**

To complete part no., specify:  
 Inlet style: 1, 2 or 3  
 Outlet style: 1, 2 or 4

Example: To order a 1/2" Turf Swivel Joint Kit with a Spigot inlet and an FIPT outlet, the part number is: ST524-400

**4-Elb Swivel Joint Kits**

ST5__-400	1/2	10	0	030	24.28
ST7__-400	3/4	10	0	030	27.27
ST9__-400	1	10	0	030	32.89

**Turf Swivel Joints**

Complete Factory Assembly.  
 Available in sizes 1/2", 3/4"  
 and 1" with the following Lay Length  
 Options:

Choice of the following Inlet & Outlet  
 Options:

- 8" = 8L
- 12" = 12L
- 15" = 15L
- 19" = 19L

- |                   |                    |
|-------------------|--------------------|
| <b>Inlet Code</b> | <b>Outlet Code</b> |
| 1 = Socket        | 1 = Socket         |
| 2 = Spigot        | 2 = Mipt           |
| 3 = Mipt          | 4 = Fipt           |

To complete part no., specify:  
 Inlet style: 1, 2, or 3  
 Outlet style: 1, 2, or 4

Example: To order a 1/2" 3-Elb Turf Swivel Joint with an 8" lay length, a Spigot inlet and an FIPT outlet, the part number is: ST524-208

**3-Elb Turf Swivel Joint**

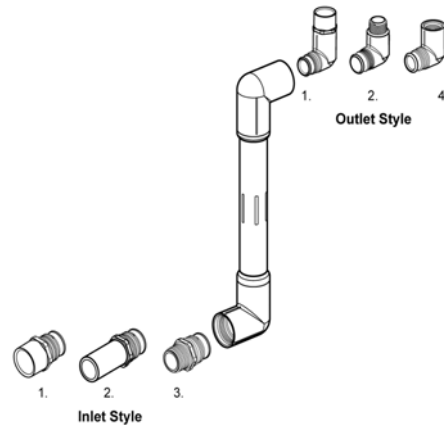

**4-Elb Turf Swivel Joint**

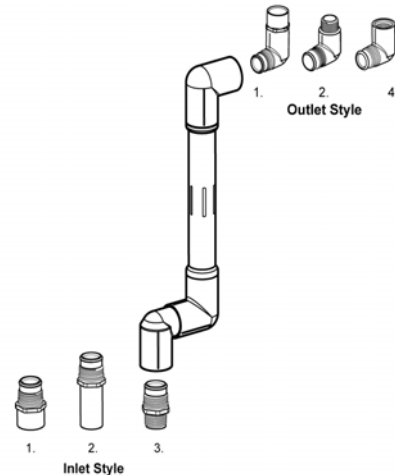

**Turf Swivel Joints**

Part Number	Size	Std Pk	Mstr Ctn	Prod Code	MSRP
<b>3-Elb Turf Swivel Joints</b>					
ST5__-208	1/2X8L	10	0	030	35.85



Irrigation & Turf Product  
**Turf Swivel Joints**

**Turf Swivel Joints**

Turf Swivel Joints (continued)

Part Number	Size	Std Pk	Mstr Ctn	Prod Code	MSRP
<b>3-ElI Turf Swivel Joints</b>					
ST5_-212	1/2X12L	10	0	030	36.28
ST5_-215	1/2X15L	10	0	030	37.40
ST5_-219	1/2X19L	10	0	030	38.59
ST7_-208	3/4X8L	10	0	030	38.65
ST7_-212	3/4X12L	10	0	030	40.48
ST7_-215	3/4X15L	10	0	030	41.26
ST7_-219	3/4X19L	10	0	030	42.25
ST9_-208	1X8L	10	0	030	42.56
ST9_-212	1X12L	10	0	030	43.91
ST9_-215	1X15L	10	0	030	45.04
ST9_-219	1X19L	10	0	030	46.59
ST57_-208	1/2X3/4X8L	10	0	030	35.85
ST57_-212	1/2X3/4X12L	10	0	030	36.28
ST57_-215	1/2X3/4X15L	10	0	030	37.40
ST57_-219	1/2X3/4X19L	10	0	030	38.59
ST75_-208	3/4X1/2X8L	10	0	030	38.65
ST75_-212	3/4X1/2X12L	10	0	030	40.48
ST75_-215	3/4X1/2X15L	10	0	030	41.26
ST75_-219	3/4X1/2X19L	10	0	030	41.26

**4-ElI Turf Swivel Joints**

ST5_-408	1/2X8L	10	0	030	36.62
ST5_-412	1/2X12L	10	0	030	37.05
ST5_-415	1/2X15L	10	0	030	38.08
ST5_-419	1/2X19L	10	0	030	39.20
ST7_-408	3/4X8L	10	0	030	39.42
ST7_-412	3/4X12L	10	0	030	41.17
ST7_-415	3/4X15L	10	0	030	41.95
ST7_-419	3/4X19L	10	0	030	42.85
ST9_-408	1X8L	10	0	030	44.78
ST9_-412	1X12L	10	0	030	46.02
ST9_-415	1X15L	10	0	030	47.14
ST9_-419	1X19L	10	0	030	48.60
ST57_-408	1/2X3/4X8L	10	0	030	36.62
ST57_-412	1/2X3/4X12L	10	0	030	37.05
ST57_-415	1/2X3/4X15L	10	0	030	38.08
ST57_-419	1/2X3/4X19L	10	0	030	39.20
ST75_-408	3/4X1/2X8L	10	0	030	41.26
ST75_-412	3/4X1/2X12L	10	0	030	42.85
ST75_-415	3/4X1/2X15L	10	0	030	42.85
ST75_-419	3/4X1/2X19L	10	0	030	42.85

**Compact Turf Swivel Joints**

Factory Assembled  
 All Inlets are Swivel Male Threads  
 Three Outlet Choices:

Series ST11 & ST41 = Female Pipe Threads

Series ST12 & ST42 = Swivel Male Pipe Threads

Series ST13 & ST43 = Male Pipe Threads

Also available in 1" MBSP inlet x 1" MBSP outlet. Contact Spears® for MSRP and availability.

Part Number	Size	Std Pk	Mstr Ctn	Prod Code	MSRP
-------------	------	-----------	-------------	--------------	------

**3-ElI Compact Turf Swivel Joints**

Swivel Mipt x Fipt



ST1105	1/2	10	0	030	22.87
ST1107	3/4	10	0	030	25.83
ST1110	1	10	0	030	30.07

**3-ElI Compact Turf Swivel Joints**

Swivel Mipt x Swivel Mipt



ST1205	1/2	10	0	030	22.87
ST1207	3/4	10	0	030	25.83
ST1210	1	10	0	030	30.07

**3-ElI Compact Turf Swivel Joints**

Swivel Mipt x Mipt



ST1305	1/2	10	0	030	22.87
ST1307	3/4	10	0	030	25.83
ST1310	1	10	0	030	30.07

**4-ElI Compact Turf Swivel Joints**

Swivel Mipt x Fipt



ST4105	1/2	10	0	030	24.28
ST4107	3/4	10	0	030	27.27