



# Turf Swivel Joints



## PRODUCT

Contact Spears® for any Information not found.



**Turf Swivel Kits**

**3-Elb Swivel Joint Kits**

Complete kit for field assembly with any length of user supplied pipe. Kit includes upper and lower Elbow assemblies with choice of the following Inlet & Outlet Options:

Inlet Code:  
 1 = Socket  
 2 = Spigot  
 3 = Mipt

Outlet Code:  
 1= Socket  
 2= Mipt  
 4 = Fipt

**Outlet Style**

To complete part no., specify:  
 Inlet style: 1, 2 or 3  
 Outlet style: 1, 2 or 4

Example: To order a 1/2" Turf Swivel Joint Kit with a Spigot inlet and an FIPT outlet, the part number is: ST524-100

**Turf Swivel Joint Kit**

Part Number	Size	Std Pk	Mstr Ctn	Prod Code	MSRP
<b>3-Elb Swivel Joint Kits</b>					
ST5__-100	1/2	10	0	030	22.87
ST7__-100	3/4	10	0	030	25.83
ST9__-100	1	10	0	030	30.06

**4-Elb Swivel Joint Kits**

Complete kit for field assembly with any length of user supplied pipe. Kit includes upper and lower Elbow assemblies with choice of the following Inlet & Outlet Options:

Inlet Code:  
 1 = Socket  
 2 = Spigot  
 3 = Mipt

Outlet Code:  
 1= Socket  
 2= Mipt  
 4 = Fipt

**Outlet Style**

To complete part no., specify:  
 Inlet style: 1, 2 or 3  
 Outlet style: 1, 2 or 4

Example: To order a 1/2" Turf Swivel Joint Kit with a Spigot inlet and an FIPT outlet, the part number is: ST524-400

**4-Elb Swivel Joint Kits**

ST5__-400	1/2	10	0	030	24.28
ST7__-400	3/4	10	0	030	27.27
ST9__-400	1	10	0	030	32.89

**Turf Swivel Joints**

Complete Factory Assembly.  
 Available in sizes 1/2", 3/4"  
 and 1" with the following Lay Length  
 Options:

Choice of the following Inlet & Outlet  
 Options:

- 8" = 8L
- 12" = 12L
- 15" = 15L
- 19" = 19L

- |                   |                    |
|-------------------|--------------------|
| <b>Inlet Code</b> | <b>Outlet Code</b> |
| 1 = Socket        | 1 = Socket         |
| 2 = Spigot        | 2 = Mipt           |
| 3 = Mipt          | 4 = Fipt           |

To complete part no., specify:  
 Inlet style: 1, 2, or 3  
 Outlet style: 1, 2, or 4

Example: To order a 1/2" 3-Elb Turf Swivel Joint with an 8" lay length, a Spigot inlet and an FIPT outlet, the part number is: ST524-208

**3-Elb Turf Swivel Joint**

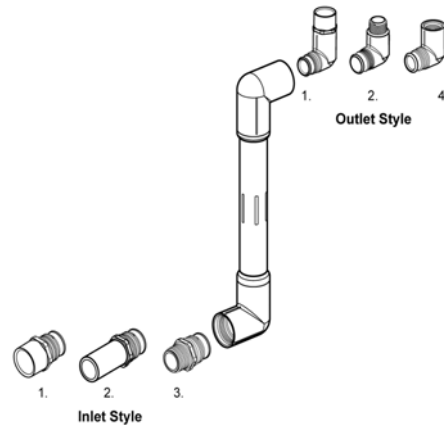

**4-Elb Turf Swivel Joint**

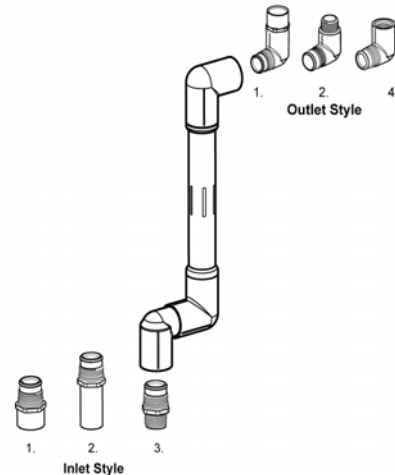

**Turf Swivel Joints**

Part Number	Size	Std Pk	Mstr Ctn	Prod Code	MSRP
<b>3-Elb Turf Swivel Joints</b>					
ST5__-208	1/2X8L	10	0	030	35.85



Irrigation & Turf Product  
**Turf Swivel Joints**

**Turf Swivel Joints**

Turf Swivel Joints (continued)

Part Number	Size	Std Pk	Mstr Ctn	Prod Code	MSRP
<b>3-ElI Turf Swivel Joints</b>					
ST5_-212	1/2X12L	10	0	030	36.28
ST5_-215	1/2X15L	10	0	030	37.40
ST5_-219	1/2X19L	10	0	030	38.59
ST7_-208	3/4X8L	10	0	030	38.65
ST7_-212	3/4X12L	10	0	030	40.48
ST7_-215	3/4X15L	10	0	030	41.26
ST7_-219	3/4X19L	10	0	030	42.25
ST9_-208	1X8L	10	0	030	42.56
ST9_-212	1X12L	10	0	030	43.91
ST9_-215	1X15L	10	0	030	45.04
ST9_-219	1X19L	10	0	030	46.59
ST57_-208	1/2X3/4X8L	10	0	030	35.85
ST57_-212	1/2X3/4X12L	10	0	030	36.28
ST57_-215	1/2X3/4X15L	10	0	030	37.40
ST57_-219	1/2X3/4X19L	10	0	030	38.59
ST75_-208	3/4X1/2X8L	10	0	030	38.65
ST75_-212	3/4X1/2X12L	10	0	030	40.48
ST75_-215	3/4X1/2X15L	10	0	030	41.26
ST75_-219	3/4X1/2X19L	10	0	030	41.26

**4-ElI Turf Swivel Joints**

ST5_-408	1/2X8L	10	0	030	36.62
ST5_-412	1/2X12L	10	0	030	37.05
ST5_-415	1/2X15L	10	0	030	38.08
ST5_-419	1/2X19L	10	0	030	39.20
ST7_-408	3/4X8L	10	0	030	39.42
ST7_-412	3/4X12L	10	0	030	41.17
ST7_-415	3/4X15L	10	0	030	41.95
ST7_-419	3/4X19L	10	0	030	42.85
ST9_-408	1X8L	10	0	030	44.78
ST9_-412	1X12L	10	0	030	46.02
ST9_-415	1X15L	10	0	030	47.14
ST9_-419	1X19L	10	0	030	48.60
ST57_-408	1/2X3/4X8L	10	0	030	36.62
ST57_-412	1/2X3/4X12L	10	0	030	37.05
ST57_-415	1/2X3/4X15L	10	0	030	38.08
ST57_-419	1/2X3/4X19L	10	0	030	39.20
ST75_-408	3/4X1/2X8L	10	0	030	41.26
ST75_-412	3/4X1/2X12L	10	0	030	42.85
ST75_-415	3/4X1/2X15L	10	0	030	42.85
ST75_-419	3/4X1/2X19L	10	0	030	42.85

**Compact Turf Swivel Joints**

Factory Assembled  
 All Inlets are Swivel Male Threads  
 Three Outlet Choices:

Series ST11 & ST41 = Female Pipe Threads

Series ST12 & ST42 = Swivel Male Pipe Threads

Series ST13 & ST43 = Male Pipe Threads

Also available in 1" MBSP inlet x 1" MBSP outlet. Contact Spears® for MSRP and availability.

Part Number	Size	Std Pk	Mstr Ctn	Prod Code	MSRP
-------------	------	-----------	-------------	--------------	------

**3-ElI Compact Turf Swivel Joints**

Swivel Mipt x Fipt



ST1105	1/2	10	0	030	22.87
ST1107	3/4	10	0	030	25.83
ST1110	1	10	0	030	30.07

**3-ElI Compact Turf Swivel Joints**

Swivel Mipt x Swivel Mipt



ST1205	1/2	10	0	030	22.87
ST1207	3/4	10	0	030	25.83
ST1210	1	10	0	030	30.07

**3-ElI Compact Turf Swivel Joints**

Swivel Mipt x Mipt



ST1305	1/2	10	0	030	22.87
ST1307	3/4	10	0	030	25.83
ST1310	1	10	0	030	30.07

**4-ElI Compact Turf Swivel Joints**

Swivel Mipt x Fipt



ST4105	1/2	10	0	030	24.28
ST4107	3/4	10	0	030	27.27

Irrigation & Turf Product  
**Turf Swivel Joints**



**Compact Turf Swivel Joints**

Part Number	Size	Std Pk	Mstr Ctn	Prod Code	MSRP
-------------	------	--------	----------	-----------	------

**4-El Compact Turf Swivel Joints (continued)**

**Swivel Mipt x Mipt**

ST4110	1	10	0	030	32.89
--------	---	----	---	-----	-------



**4-El Compact Turf Swivel Joints**

**Swivel Mipt x Swivel Mipt**

ST4205	1/2	10	0	030	24.28
ST4207	3/4	10	0	030	27.27
ST4210	1	10	0	030	32.89



**4-El Compact Turf Swivel Joints**

**Swivel Mipt x Mipt**

ST4305	1/2	10	0	030	24.28
ST4307	3/4	10	0	030	27.27
ST4310	1	10	0	030	32.89

**Pressure Regulated Swivel Joints**

3-El Pressure Regulated Swivel Joint 4-El Pressure Regulated Swivel Joint



**Pressure Regulated Turf Swivel Joints**

Part Number	Size	Std Pk	Mstr Ctn	Prod Code	MSRP
-------------	------	--------	----------	-----------	------

**3-El - Mipt x Mipt**

ST73PR-208	3/4X8L	10	0	030	71.59
ST73PR-212	3/4X12L	10	0	030	73.54
ST73PR-215	3/4X15L	10	0	030	74.39
ST73PR-219	3/4X19L	10	0	030	75.39
ST93PR-208	1X8L	10	0	030	77.40
ST93PR-212	1X12L	10	0	030	78.81
ST93PR-215	1X15L	10	0	030	80.03

**Pressure Regulated Turf Swivel Joints (continued)**

Part Number	Size	Std Pk	Mstr Ctn	Prod Code	MSRP
-------------	------	--------	----------	-----------	------

**3-El - Mipt x Mipt**

ST93PR-219	1X19L	10	0	030	81.67
------------	-------	----	---	-----	-------

**4-El - Mipt x Mipt**

ST73PR-408	3/4X8L	10	0	030	75.56
ST73PR-412	3/4X12L	10	0	030	77.53
ST73PR-415	3/4X15L	10	0	030	78.36
ST73PR-419	3/4X19L	10	0	030	79.38
ST93PR-408	1X8L	10	0	030	83.75
ST93PR-412	1X12L	10	0	030	85.14
ST93PR-415	1X15L	10	0	030	86.37
ST93PR-419	1X19L	10	0	030	87.99

Complete Factory Assembly. Available in sizes 3/4" and 1" with Mipt Inlet x Mipt Outlet and the following Lay Length Options:

8"	=	8L
12"	=	12L
15"	=	15L
19"	=	19L

Maintains constant, uniform pressure to sprinkler at the following pre-set nominal values:

45 psi for 3/4" Turf Swivel Joint

70 psi for 1" Turf Swivel Joint

Not recommended for use in systems with pressures equal to or less than regulated pressures above. Pressure Rating @ 73°F (23°C), Water 315 psi

**Turf Swivel Joint Replacement Parts**

**Turf Swivel Joint Coupling**



**FAT x FAT**

ST430-007	3/4	1	350	030	7.55
ST430-010	1	1	240	030	10.03

**Turf Swivel Joint 90° Elbow**



**FAT x FAT**

ST1101-005	1/2	1	300	030	4.37
ST1101-007	3/4	1	250	030	5.04
ST1101-101	3/4X1/2	1	270	030	4.60
ST1101-010	1	1	175	030	8.29



Irrigation & Turf Product  
**Turf Swivel Joints**

**Turf Swivel Joint Replacement Parts**

Part Number	Size	Std Pk	Mstr Ctn	Prod Code	MSRP
-------------	------	--------	----------	-----------	------

**Turf Swivel Joint 90° Elbow**

**FAT x SOC**



ST1102-005	1/2	1	350	030	4.37
ST1102-007	3/4	1	250	030	5.04
ST1102-010	1	1	160	030	8.29

**Turf Swivel Joint 90° Street Ell**

**MAT x FAT**



ST425-005	1/2	1	200	030	6.35
ST425-007	3/4	1	300	030	6.78
ST425-010	1	1	200	030	9.43

**Turf Swivel Joint Socket Inlet #1**

**Socket x MAT**



ST436-005	1/2	1	350	030	4.06
ST436-007	3/4	1	50	030	4.49
ST436-010	1	1	100	030	8.44

**Turf Swivel Joint Spigot Inlet #2**

**Spigot x MAT**



ST105-035	1/2	1	350	030	4.35
ST107-035	3/4	1	50	030	4.85
ST110-040	1	1	140	030	8.84

**Turf Swivel Joint Male Thread Inlet #3**

**Mipt x MAT**



ST205-020	1/2	1	25	030	3.83
ST207-020	3/4	1	350	030	4.49
ST210-020	1	1	150	030	4.88

**Turf Swivel Joint Socket Outlet #1**

**MAT x Socket**



ST410-005	1/2	1	50	030	8.65
ST410-007	3/4	1	10	030	9.48
ST410-010	1	1	25	030	9.94

Part Number	Size	Std Pk	Mstr Ctn	Prod Code	MSRP
-------------	------	--------	----------	-----------	------

**Turf Swivel Joint Male Thread Outlet #2**

**MAT x Mipt**



ST408-005	1/2	1	250	030	6.35
ST408-007	3/4	1	25	030	6.78
ST408-010	1	1	100	030	10.03

**Turf Swivel Joint Female Thread Outlet #4**

**MAT x Fipt**



ST412-005	1/2	1	250	030	6.35
ST412-007	3/4	1	25	030	6.78
ST412-010	1	1	200	030	9.43

**Turf Swivel Joint Molded Nipples**

**MAT x MAT**



ST207-065	3/4X6-1/2	1	200	030	8.97
ST207-105	3/4X10-1/2	1	25	030	20.67
ST210-065	1X6-1/2	1	50	030	11.54
ST210-105	1X10-1/2	1	25	030	27.34

**Turf Swivel Joint O-ring Seal**

Pack of 100



BPB-113	1/2	1	10	891	3.25
BPB-115	3/4	1	10	891	3.58
BPB-120	1	1	10	891	5.01