



Fabricated Fittings Product

PVC 80, 100 & 125 PSI PIP Fabricated Fittings

Tees

Size	80 PSI	100 PSI	125 PSI
	Prod Code:310	Prod Code:320	Prod Code:330
	Part Number	Part Number	Part Number

Tee (Socket x Socket x Socket)

6	290-102502 94.26	300-102502 112.79	3301-060P 113.40
6X2	290-102499 65.87	300-102499 76.20	3301-528P 85.52
6X3	290-102500 70.98	300-102500 81.34	3301-530P 92.02
6X4	290-102501 73.61	300-102501 85.20	3301-532P 95.46
8	290-102507 162.56	300-102507 166.57	3301-080P 227.34
8X2	290-102503 81.34	300-102503 94.26	3301-578P 128.96
8X3	290-102504 90.37	300-102504 101.97	3301-580P 140.54
8X4	290-102505 101.97	300-102505 111.09	3301-582P 152.02
8X6	290-102506 121.35	300-102506 136.88	3301-585P 188.36
10	290-102513 235.02	300-102513 267.37	3301-100P 339.35
10X2	290-102508 118.79	300-102508 130.43	3301-621P 179.28
10X3	290-102509 130.43	300-102509 166.57	3301-623P 228.14
10X4	290-102510 151.11	300-102510 170.45	3301-624P 235.03
10X6	290-102511 166.57	300-102511 174.34	3301-626P 257.86
10X8	290-102512 192.44	300-102512 232.47	3301-628P 319.80
12	290-102520 333.20	300-102520 426.15	3301-120P 533.54
12X2	290-102514 157.53	300-102514 188.48	3301-661P 281.01
12X3	290-102515 185.99	300-102515 225.98	3301-663P 310.60
12X4	290-102516 210.49	300-102516 250.54	3301-664P 342.98
12X6	290-102517 222.09	300-102517 272.46	3301-666P 375.40
12X8	290-102518 262.16	300-102518 321.56	3301-668P 444.40
12X10	290-102519 302.19	300-102519 370.64	3301-670P 493.06
15	290-102528 623.77	300-102528 733.57	3301-150P 953.14
15X2	290-102521 290.59	300-102521 339.63	3301-721P 426.15
15X3	290-102522 306.08	300-102522 357.74	3301-723P 453.36
15X4	290-102523 315.12	300-102523 373.24	3301-724P 468.80

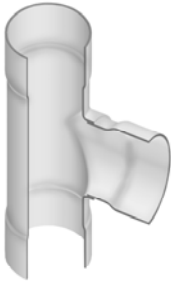

Tee (Socket x Socket x Socket) (continued)

Size	80 PSI	100 PSI	125 PSI
	Prod Code:310 Part Number	Prod Code:320 Part Number	Prod Code:330 Part Number
15X6	290-102524 342.20	300-102524 410.67	3301-726P 530.80
15X8	290-102525 395.17	300-102525 459.77	3301-728P 610.91
15X10	290-102526 448.14	300-102526 543.74	3301-730P 690.94
15X12	290-102527 512.67	300-102527 610.91	3301-732P 797.55
18	290-102537 966.04	300-102537 1126.17	3301-180P 1604.09
18X2	290-102529 504.77	300-102529 551.42	3301-781P 672.87
18X3	290-102530 520.47	300-102530 565.64	3301-783P 752.92
18X4	290-102531 575.99	300-102531 622.52	3301-784P 802.02
18X6	290-102532 592.78	300-102532 644.44	3301-786P 821.40
18X8	290-102533 617.34	300-102533 671.57	3301-788P 916.96
18X10	290-102534 652.20	300-102534 721.95	3301-790P 1002.19
18X12	290-102535 721.95	300-102535 857.57	3301-792P 1126.17
18X15	290-102536 836.89	300-102536 1037.07	3301-795P 1310.93
21	290-102558 1782.29	300-102558 2097.43	3301-210P 2390.60
21X2	290-102548 731.79	300-102548 919.54	3301-841P 1046.12
21X3	290-102549 749.63	300-102549 925.98	3301-843P 1064.23
21X4	290-102550 774.88	300-102550 936.34	3301-844P 1110.71
21X6	290-102551 821.40	300-102551 1135.21	3301-846P 1273.45
21X8	290-102552 876.91	300-102552 1168.80	3301-848P 1326.37
21X10	290-102553 935.02	300-102553 1212.71	3301-850P 1388.39
21X12	290-102554 1024.18	300-102554 1224.36	3301-852P 1726.76
21X15	290-102555 1128.78	300-102555 1403.85	3301-855P 1973.44
21X18	290-102556 1317.31	300-102556 1604.09	3301-858P 2251.16
24	290-102570 2433.26	300-102570 2806.47	3301-240P 2868.51
24X2	290-102559 966.04	300-102559 1141.68	3301-901P 1233.36
24X3	290-102560 1028.01	300-102560 1203.69	3301-903P 1295.37
24X4	290-102561 1086.17	300-102561 1295.37	3301-904P 1388.39
24X6	290-102562 1144.29	300-102562 1388.39	3301-906P 1480.08

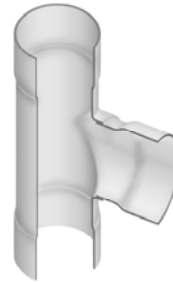

Fabricated Fittings Product
PVC 80, 100 & 125 PSI PIP Fabricated Fittings



Tees

	Size	80 PSI	100 PSI	125 PSI
		Prod Code:310	Prod Code:320	Prod Code:330
		Part Number	Part Number	Part Number

Tee (Socket x Socket x Socket) (continued)

	24X8	290-102563 1219.19	300-102563 1480.08	3301-908P 1604.09
	24X10	290-102564 1255.34	300-102564 1604.09	3301-910P 1726.76
	24X12	290-102565 1357.40	300-102565 1726.76	3301-912P 1850.74
	24X15	290-102566 1490.37	300-102566 1881.76	3301-915P 2035.46
	24X18	290-102567 1697.06	300-102567 2128.42	3301-918P 2313.13
	24X21	290-102569 1908.83	300-102569 2280.78	3301-921P 2744.48
	27	2901-270 3686.22	3001-270 4367.19	3301-270P 5403.64
	27X4	2901-934 1314.28	3001-934 1650.16	3301-934P 2061.08
	27X6	2901-936 1386.76	3001-936 1776.62	3301-936P 2220.58
	27X8	2901-938 1476.17	3001-938 1901.72	3301-938P 2378.62
	27X10	2901-940 1495.73	3001-940 2033.44	3301-940P 2543.22
	27X12	2901-942 1643.86	3001-942 2196.85	3301-942P 2746.01
	27X15	2901-945 1804.34	3001-945 2418.11	3301-945P 3023.82
	27X18	2901-948 2055.71	3001-948 2741.96	3301-948P 3426.79
	27X21	2901-951 2312.80	3001-951 2917.15	3301-951P 3645.59
	27X24	2901-954 2948.79	3001-954 3602.03	3301-954P 4501.49

Tee (Gasket x Spigot x Gasket)

	6	290-103062 193.71	300-103062 200.16	3301-060232P 213.56
	6X4	290-103061 167.86	300-103061 187.25	3301-532232P 201.78
	8	290-103067 245.40	300-103067 267.37	3301-080232P 321.14
	8X4	290-103065 206.65	300-103065 227.27	3301-582232P 241.05
	8X6	290-103066 232.47	300-103066 240.22	3301-585232P 281.07
	10	290-103073 366.79	300-103073 406.83	3301-100232P 481.98
	10X4	290-103070 320.28	300-103070 333.20	3301-624232P 348.46
	10X6	290-103071 326.72	300-103071 347.39	3301-626232P 387.46
	10X8	290-103072 360.31	300-103072 373.24	3301-628232P 421.18
	12	290-103080 506.25	300-103080 552.77	3301-120232P 668.35

Tee (Gasket x Spigot x Gasket) (continued)

Size	80 PSI	100 PSI	125 PSI
	Prod Code:310 Part Number	Prod Code:320 Part Number	Prod Code:330 Part Number
12X4	290-103076 373.24	300-103076 419.71	3301-664232P 467.61
12X6	290-103077 383.56	300-103077 433.91	3301-666232P 501.72
12X8	290-103078 444.26	300-103078 446.86	3301-668232P 534.88
12X10	290-103079 457.20	300-103079 493.33	3301-670232P 601.63
15	290-103088 808.47	300-103088 999.63	3301-150232P 1198.48
15X4	290-103083 599.25	300-103083 632.80	3301-724232P 833.01
15X6	290-103084 606.72	300-103084 733.57	3301-726232P 885.94
15X8	290-103085 639.27	300-103085 746.49	3301-728232P 919.54
15X10	290-103086 688.34	300-103086 765.88	3301-730232P 966.04
15X12	290-103087 733.57	300-103087 833.01	3301-732232P 1027.65
18	290-103097 1288.91	300-103097 1498.14	3301-180232P 1930.81
18X4	290-103091 777.47	300-103091 866.59	3301-784232P 1065.47
18X6	290-103092 833.01	300-103092 932.44	3301-786232P 1166.23
18X8	290-103093 851.11	300-103093 1052.60	3301-788232P 1265.68
18X10	290-103094 946.68	300-103094 1099.07	3301-790232P 1365.13
18X12	290-103095 1026.74	300-103095 1166.23	3301-792232P 1432.33
18X15	290-103096 1073.23	300-103096 1232.08	3301-795232P 1531.73
21	2901-210232 2028.98	3001-210232 2496.57	3301-210232P 3049.27
21X4	290-103110 1206.29	300-103110 1465.89	3301-844232P 1764.22
21X6	290-103111 1219.19	300-103111 1498.14	3301-846232P 1797.78
21X8	290-103112 1283.76	300-103112 1578.24	3301-848232P 1884.31
21X10	290-103113 1323.79	300-103113 1598.88	3301-850232P 1944.99
21X12	290-103114 1452.99	300-103114 1698.35	3301-852232P 2131.01
21X15	290-103115 1573.08	300-103115 1764.22	3301-855232P 2297.59
21X18	290-103116 1779.72	300-103116 2131.01	3301-858232P 2597.26
24	2901-240232 4550.49	3001-240232 4820.37	3301-240232P 6571.81
24X6	2901-906232 3235.95	3001-906232 3666.65	3301-906232P 4583.36
24X8	2901-908232 3405.59	3001-908232 3802.22	3301-908232P 4820.21



Fabricated Fittings Product
PVC 80, 100 & 125 PSI PIP Fabricated Fittings

Tees

Size	80 PSI	100 PSI	125 PSI
	Prod Code:310	Prod Code:320	Prod Code:330
	Part Number	Part Number	Part Number

Tee (Gasket x Spigot x Gasket) (continued)

	24X10	2901-910232 3579.76	3001-910232 3870.83	3301-910232P 5136.27
	24X12	2901-912232 3772.92	3001-912232 3972.19	3301-912232P 5364.16
	24X15	2901-915232 3970.66	3001-915232 4142.12	3301-915232P 5635.46
	24X18	2901-918232 4176.23	3001-918232 4344.86	3301-918232P 5906.87
	24X21	2901-921232 4397.52	3001-921232 4617.48	3301-921232P 6246.53
	27	2901-270232 6845.38	3001-270232 5054.37	3301-270232P 6364.59
	27X6	2901-936232 4044.49	3001-936232 4583.22	3301-936232P 5771.17
	27X8	2901-938232 4256.47	3001-938232 4820.29	3301-938232P 6042.40
	27X10	2901-940232 4475.29	3001-940232 5091.65	3301-940232P 6313.76
	27X12	2901-942232 4717.55	3001-942232 3179.41	3301-942232P 4416.53
	27X15	2901-945232 4965.06	3001-945232 5635.46	3301-945232P 6857.62
	27X18	2901-948232 5221.98	3001-948232 5940.97	3301-948232P 7400.26
	27X21	2901-951232 5497.26	3001-951232 6246.66	3301-951232P 7807.23
	27X24	2901-954232 5786.95	3001-954232 6517.98	3301-954232P 8248.54

Tee (Gasket x Gasket x Gasket)

	6	290-103174 193.71	300-103174 200.16	3301-0602P 213.56
	6X4	290-103173 167.86	300-103173 187.25	3301-5322P 201.78
	8	290-103179 245.40	300-103179 267.37	3301-0802P 321.14
	8X4	290-103177 206.65	300-103177 227.27	3301-5822P 241.05
	8X6	290-103178 232.47	300-103178 240.22	3301-5852P 281.07
	10	290-103185 366.79	300-103185 406.83	3301-1002P 481.98
	10X4	290-103182 320.28	300-103182 333.20	3301-6242P 348.46
	10X6	290-103183 326.72	300-103183 347.39	3301-6262P 387.46
	10X8	290-103184 360.31	300-103184 373.24	3301-6282P 421.18
	12	290-103192 506.25	300-103192 552.77	3301-1202P 668.35
	12X4	290-103188 373.24	300-103188 419.71	3301-6642P 467.61
	12X6	290-103189 383.56	300-103189 433.91	3301-6662P 521.12

Size	80 PSI	100 PSI	125 PSI
	Prod Code:310	Prod Code:320	Prod Code:330
	Part Number	Part Number	Part Number

Tee (Gasket x Gasket x Gasket) (continued)

	12X8	290-103190 444.26	300-103190 446.86	3301-6682P 534.88
	12X10	290-103191 457.20	300-103191 493.33	3301-6702P 601.63
	15	290-103200 808.47	300-103200 999.63	3301-1502P 1198.48
	15X4	290-103195 599.25	300-103195 632.80	3301-7242P 833.01
	15X6	290-103196 606.72	300-103196 733.57	3301-7262P 885.94
	15X8	290-103197 639.27	300-103197 746.49	3301-7282P 919.54
	15X10	290-103198 688.34	300-103198 765.88	3301-7302P 966.04
	15X12	290-103199 733.57	300-103199 833.01	3301-7322P 1031.93
	18	290-103209 1288.91	300-103209 1498.14	3301-1802P 1930.81
	18X4	290-103203 777.47	300-103203 866.59	3301-7842P 1065.47
	18X6	290-103204 833.01	300-103204 932.44	3301-7862P 1166.23
	18X8	290-103205 851.11	300-103205 1052.60	3301-7882P 1265.68
	18X10	290-103206 946.68	300-103206 1099.07	3301-7902P 1365.13
	18X12	290-103207 1026.74	300-103207 1166.23	3301-7922P 1432.33
	18X15	290-103208 1073.23	300-103208 1232.08	3301-7952P 1531.73
	21	290-103230 2028.98	300-103230 2496.57	3301-2102P 3049.27
	21X4	290-103222 1206.29	300-103222 1465.89	3301-8442P 1764.22
	21X6	290-103223 1219.19	300-103223 1498.14	3301-8462P 1797.78
	21X8	290-103224 1283.76	300-103224 1578.24	3301-8482P 1884.31
	21X10	290-103225 1323.79	300-103225 1598.88	3301-8502P 1944.99
	21X12	290-103226 1452.99	300-103226 1698.35	3301-8522P 2131.01
	21X15	290-103227 1573.08	300-103227 1764.22	3301-8552P 2297.59
	21X18	290-103228 1779.72	300-103228 2131.01	3301-8582P 2597.26
	24	2901-2402 4550.49	3001-2402 4820.37	3301-2402P 6571.81
	24X6	2901-9062 3235.95	3001-9062 3666.65	3301-9062P 4583.36
	24X8	2901-9082 3405.59	3001-9082 3802.22	3301-9082P 4820.21
	24X10	2901-9102 3579.76	3001-9102 3870.83	3301-9102P 5136.27
	24X12	2901-9122 3772.92	3001-9122 3972.19	3301-9122P 5364.16

Fabricated Fittings Product
PVC 80, 100 & 125 PSI PIP Fabricated Fittings



Tees

Size	80 PSI	100 PSI	125 PSI
	Prod Code:310	Prod Code:320	Prod Code:330
	Part Number	Part Number	Part Number

Tee (Gasket x Gasket x Gasket) (continued)

	24X15	2901-9152 3970.66	3001-9152 4142.12	3301-9152P 5635.46
	24X18	2901-9182 4176.23	3001-9182 4344.86	3301-9182P 5906.87
	24X21	2901-9212 4397.52	3001-9212 4617.48	3301-9212P 6246.53
	27	2901-2702 6845.38	3001-2702 7637.43	3301-2702P 6907.85
	27X6	2901-9362 4044.49	3001-9362 4583.22	3301-9362P 5771.17
	27X8	2901-9382 4256.47	3001-9382 4820.29	3301-9382P 6042.40
	27X10	2901-9402 4475.29	3001-9402 5091.65	3301-9402P 6313.76
	27X12	2901-9422 2835.08	3001-9422 5364.20	3301-9422P 4811.23
	27X15	2901-9452 4965.06	3001-9452 5635.46	3301-9452P 6857.62
	27X18	2901-9482 5221.98	3001-9482 5940.97	3301-9482P 7400.26
	27X21	2901-9512 5497.26	3001-9512 6246.66	3301-9512P 7807.23
	27X24	2901-9542 5786.95	3001-9542 6517.98	3301-9542P 8248.54
	Size	80 PSI Prod Code:310 Part Number	100 PSI Prod Code:320 Part Number	125 PSI Prod Code:330 Part Number

Reinforced Tee (Socket x Socket x Fipt)

	6X2	---	300-202152 79.23	3302-528P 120.57
	6X3	---	300-202154 86.48	3302-530P 138.15
	6X4	---	300-202155 96.84	3302-532P 142.05
	8X2	---	300-202157 120.09	3302-578P 195.14
	8X3	---	300-202159 126.53	3302-580P 208.37
	8X4	---	300-202160 136.88	3302-582P 176.68
	10X2	---	300-202162 164.03	3302-621P 220.28
	10X3	---	300-202164 201.44	3302-623P 272.86
	10X4	---	300-202165 215.67	3302-624P 268.49
	12X2	---	300-202167 250.54	3302-661P 271.14
	12X3	---	300-202169 277.63	3302-663P 298.05
	12X4	---	300-202170 317.68	3302-664P 348.83

Size	80 PSI	100 PSI	125 PSI
	Prod Code:310	Prod Code:320	Prod Code:330
	Part Number	Part Number	Part Number

Reinforced Tee (Socket x Socket x Fipt) (continued)

	15X2	---	300-202172 412.93	3302-721P 477.82
	15X3	---	300-202174 439.25	3302-723P 503.67
	15X4	---	300-202175 471.06	3302-724P 516.63

Reinforced Tee (Socket x Spigot x Fipt)

	6X2	---	300-202222 65.87	---
	6X3	---	300-202224 77.48	---
	6X4	---	300-202225 90.37	---
	8X2	---	300-202227 105.88	---
	8X3	---	300-202229 116.22	---
	8X4	---	300-202230 126.53	---
	10X2	---	300-202232 157.48	---
	10X3	---	300-202234 192.44	---
	10X4	---	300-202235 204.04	---
	12X2	---	300-202237 235.02	---
	12X3	---	300-202239 268.60	---
	12X4	---	300-202240 306.08	---
	15X2	---	300-202242 410.67	3302-72113P 464.94
	15X3	---	300-202244 435.22	3302-72313P 497.24
15X4	---	300-202245 463.61	3302-72413P 510.12	

Reinforced Tee (Gasket x Spigot x Fipt)

	6X2	---	300-202362 113.62	---
	6X3	---	300-202364 147.21	---
	6X4	---	300-202365 153.69	---
	8X2	---	300-202367 160.14	---
	8X3	---	300-202369 187.25	---
	8X4	---	300-202370 206.65	---



Fabricated Fittings Product

PVC 80, 100 & 125 PSI PIP Fabricated Fittings

Tees

	Size	80 PSI	100 PSI	125 PSI
		Prod Code:310	Prod Code:320	Prod Code:330
		Part Number	Part Number	Part Number

Reinforced Tee (Gasket x Spigot x Fipt) (continued)

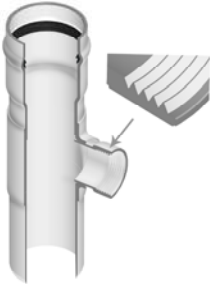
	10X2	---	300-202372 240.22	---
	10X3	---	300-202374 253.11	---
	10X4	---	300-202375 263.42	---
	12X2	---	300-202377 333.20	---
	12X3	---	300-202379 360.31	---
	12X4	---	300-202380 373.24	---
	15X2	---	300-202382 466.23	3302-72123P 567.95
	15X3	---	300-202384 493.33	3302-72323P 608.67
	15X4	---	300-202385 533.38	3302-72423P 663.66

Reinforced Tee (Gasket x Fipt)

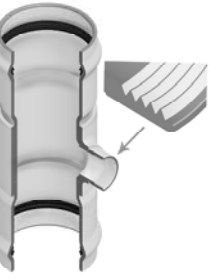
	6X2	---	300-202432 120.09	---
	6X3	---	300-202434 147.21	---
	6X4	---	300-202435 160.14	---
	8X2	---	300-202437 180.79	---
	8X3	---	300-202439 197.60	---
	8X4	---	300-202440 213.07	---
	10X2	---	300-202442 260.84	---
	10X3	---	300-202444 286.68	---
	10X4	---	300-202445 307.34	---
	12X2	---	300-202447 366.79	---
	12X3	---	300-202449 386.13	---
	12X4	---	300-202450 413.29	---
	15X2	---	300-202452 533.38	3302-7212P 651.69
	15X3	---	300-202454 552.77	3302-7232P 708.08
	15X4	---	300-202455 579.91	3302-7242P 744.65

PIP x IPS Tees

	Size	80 PIP	100 PIP	125 PIP
		Prod Code:319	Prod Code:329	Prod Code:339
		Part Number	Part Number	Part Number

PIP x IPS Tee (Socket x Socket x Socket)

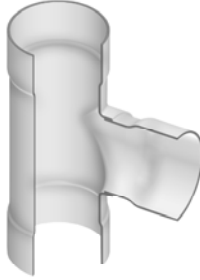
	6	2901-060PXi 88.61	3001-060PXi 155.00	3301-060PXi 113.40
	8	2901-080PXi 162.56	3001-080PXi 226.61	3301-080PXi 227.34
	8X6	2901-585PXi 223.62	3001-585PXi 252.11	3301-585PXi 177.05
	10	2901-100PXi 220.92	3001-100PXi 267.37	3301-100PXi 339.35
	10X6	2901-626PXi 156.58	300-102821 174.34	3301-626PXi 242.39
	10X8	2901-628PXi 180.89	3001-628PXi 357.88	3301-628PXi 300.61
	12	2901-120PXi 333.20	3001-120PXi 426.15	3301-120PXi 501.53
	12X6	2901-666PXi 264.78	300-102599 272.46	3301-666PXi 352.87
	12X8	2901-668PXi 246.43	300-102607 321.56	3301-668PXi 417.74
	12X10	2901-670PXi 302.19	3001-670PXi 370.64	3301-670PXi 463.48
	15X6	2901-726PXi 321.67	300-102708 410.67	3301-726PXi 498.96
	15X8	2901-728PXi 371.45	300-102709 518.04	3301-728PXi 574.25
	15X10	2901-730PXi 421.24	3001-730PXi 543.74	3301-730PXi 649.48
	15X12	2901-732PXi 481.92	300-102817 610.91	3301-732PXi 749.69
	18X6	2901-786PXi 557.21	3001-786PXi 644.44	3301-786PXi 772.12
	18X8	2901-788PXi 580.29	3001-788PXi 671.57	3301-788PXi 861.94
	18X10	2901-790PXi 652.20	3001-790PXi 721.95	3301-790PXi 942.06
	18X12	2901-792PXi 721.95	3001-792PXi 857.57	3301-792PXi 1058.60
	21X6	2901-846PXi 821.40	3001-846PXi 1134.82	3301-846PXi 1197.04
	21X8	2901-848PXi 824.29	3001-848PXi 1168.80	3301-848PXi 1246.79
	21X10	2901-850PXi 935.02	3001-850PXi 1212.71	3301-850PXi 1305.08
	21X12	2901-852PXi 962.73	3001-852PXi 1224.36	3301-852PXi 1623.16
	24X6	2901-906PXi 1144.29	3001-906PXi 1388.39	3301-906PXi 1391.28
	24X8	2901-908PXi 1219.19	3001-908PXi 1480.08	3301-908PXi 1507.85
24X10	2901-910PXi 1255.34	3001-910PXi 1604.09	3301-910PXi 1623.16	
24X12	2901-912PXi 1275.96	3001-912PXi 1726.76	3301-912PXi 1739.69	