

Fabricated Fittings Product
PVC 80, 100 & 125 PSI PIP Fabricated Fittings



Caps

Size	80 PSI	100 PSI	125 PSI
	Prod Code:310 Part Number	Prod Code:320 Part Number	Prod Code:330 Part Number

Cap (Socket)

	6	---	300-107540 54.35	---
	8	---	300-107541 69.34	---
	10	---	300-107542 111.45	---
	12	---	300-107543 146.79	---
	15	---	300-107545 239.23	---
	18	---	300-107547 467.38	---
	21	---	300-107549 715.06	---
	24	---	300-107550 977.80	---
	27	---	3047-270 1227.01	---
	30	---	3047-300 2997.96	---

Eccentric Stub Surface Reducer

Size	80 PSI	100 PSI	125 PSI
	Prod Code: 310 Part Number	Prod Code: 320 Part Number	Prod Code: 330 Part Number

Eccentric Stub Surface Reducer (Socket)

	6X2	---	3040-528E 90.24	---
	6X3	---	3040-530E 90.95	---
	6X4	---	3040-532E 94.25	---
	8X2	---	3040-578E 116.98	---
	8X3	---	3040-580E 118.28	---
	8X4	---	3040-582E 120.37	---
	8X6	---	3040-585E 132.79	---
	10X2	---	3040-621E 141.36	---
	10X3	---	3040-623E 147.88	---
	10X4	---	3040-624E 157.56	---
	10X6	---	3040-626E 162.31	---
	10X8	---	3040-628E 183.92	---
	12X2	---	3040-661E 199.82	---

Size	80 PSI	100 PSI	125 PSI
	Prod Code: 310 Part Number	Prod Code: 320 Part Number	Prod Code: 330 Part Number

Eccentric Stub Surface Reducer (Socket) (continued)

	12X4	---	3040-664E 235.14	---
	12X6	---	3040-666E 245.73	---
	12X8	---	3040-668E 251.86	---
	15X2	---	3040-721E 214.31	---
	15X3	---	3040-723E 244.85	---
	15X4	---	3040-724E 252.93	---
	15X6	---	3040-726E 258.15	---
	15X8	---	3040-728E 279.75	---
	15X10	---	3040-730E 307.24	---
	15X12	---	3040-732E 344.18	---
	18X2	---	3040-781E 497.48	---
	18X3	---	3040-783E 502.13	---
	18X4	---	3040-784E 506.96	---
	18X6	---	3040-786E 515.44	---
	18X8	---	3040-788E 537.07	---
	18X10	---	3040-790E 559.20	---
	18X12	---	3040-792E 596.16	---
	18X15	---	3040-795E 666.57	---
	21X2	---	3040-841E 618.55	---
	21X3	---	3040-843E 623.87	---
	21X4	---	3040-844E 627.38	---
	21X6	---	3040-846E 635.86	---
	21X8	---	3040-848E 657.48	---
	21X10	---	3040-850E 679.65	---
	21X12	---	3040-852E 716.60	---
	21X15	---	3040-855E 787.01	---
	21X18.701	---	3040-858E 874.23	---



Fabricated Fittings Product
PVC 80, 100 & 125 PSI PIP Fabricated Fittings & Pipe Flanges & PVC 80, 100 & 125 PSI PIP Fabricated Fittings

Eccentric Stub Surface Reducer

Size	80 PSI	100 PSI	125 PSI
	Prod Code: 310	Prod Code: 320	Prod Code: 330
	Part Number	Part Number	Part Number

Eccentric Stub Surface Reducer (Socket) (continued)

Size	80 PSI Prod Code: 310	100 PSI Prod Code: 320	125 PSI Prod Code: 330
24X2	---	3040-901E 991.96	---
24X3	---	3040-903E 999.51	---
24X6	---	3040-906E 1158.17	---
24X8	---	3040-908E 1179.80	---
24X10	---	3040-910E 1201.96	---
24X12	---	3040-912E 1238.87	---
24X15	---	3040-915E 1298.27	---
24X18	---	3040-918E 1396.55	---
27X3	---	3040-933E 1819.88	---
27X4	---	3040-934E 1821.24	---
27X6	---	3040-936E 1833.20	---
27X8	---	3040-938E 1854.82	---
27X10	---	3040-940E 1876.97	---
27X12	---	3040-942E 1913.92	---
27X15	---	3040-945E 1973.27	---
27X18	---	3040-948E 2071.56	---
27X21	---	3040-951E 2218.51	---
27X24	---	3040-954E 4824.55	---



Pipe Flanges

Part Number	Size	Std Pk	Mstr Ctn	Prod Code	MSRP
-------------	------	--------	----------	-----------	------

Flange Van Stone Style -PIP

Flange x PIP Socket

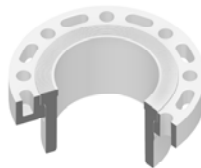

125 psi Maximum Internal Pressure Rating @ 73°F (23°C)

354-060F	6X6.140	1	4	320	148.12
354-080F	8X8.160	1	2	320	224.28
354-100F	10X10.200	1	2	320	315.36
354-120F	12X12.240	1	2	320	456.75
354-150F	14X15.300	1	0	320	1217.46

Part Number	Size	Std Pk	Mstr Ctn	Prod Code	MSRP
-------------	------	--------	----------	-----------	------

Flange Van Stone Style -PIP (continued)

Flange x PIP Socket

354-151F	16X15.300	1	0	320	1388.87
354-182F	18X18.360	1	0	320	2109.93
354-181F	18X18.701	1	0	320	2109.93
354-201F	20X22.047	1	0	320	3213.86
354-241F	24X24.803	1	0	320	4706.61

For more information, refer to 80, 100 & 125 psi PIP Fabrication Fittings.

PIP = Plastic Irrigation Pipe (dimensions are NOT the same as IPS dimensions).

Sizes 6" - 16" are furnished with Glass Filled PVC ring.
 Sizes 18" - 24" are furnished with steel ring.

Glue-On Saddles

Size	80 PSI	100 PSI	125 PSI
	Prod Code:310	Prod Code:320	Prod Code:330
	Part Number	Part Number	Part Number

Saddle (Socket)

6X2	---	300-101789 67.96	---
6X3	---	300-101797 81.56	---
6X4	---	300-101804 95.13	---
8X2	---	300-101790 67.96	---
8X3	---	300-101798 81.56	---
8X4	---	300-101805 95.13	---
8X6	---	300-101811 108.75	---
10X2	---	300-101791 110.47	---
10X3	---	300-101799 81.56	---
10X4	---	300-101806 95.13	---
10X6	---	300-101812 108.75	---
10X8	---	300-101817 122.34	---
12X2	---	300-101792 67.96	---
12X3	---	300-101800 81.56	---
12X4	---	300-101807 95.13	---
12X6	---	300-101813 108.75	---
12X8	---	300-101818 122.34	---
12X10	---	300-101822 135.91	---
15X2	---	300-101793 67.96	---

