



Fabricated Fittings Product

**PVC Low Head PIP Fabricated Fittings, Risers & Accessories**

**Non 90° Ells**

Part Number	Size	Std Pk	Mstr Ctn	Prod Code	MSRP
-------------	------	--------	----------	-----------	------

**15° Elbow (continued)**

**Socket x Socket**

280-100239	18	1	0	300	210.49
280-100240	20	1	0	300	272.46



**22-1/2° Elbow**

**Socket x Socket**

280-100354	6	1	4	300	24.55
280-100355	8	1	3	300	34.89
280-100356	10	1	2	300	50.34
280-100357	12	1	2	300	69.73
280-100358	15	1	0	300	120.09
280-100359	18	1	0	300	210.49
280-100360	20	1	0	300	272.46



**30° Elbow**

**Socket x Socket**

280-100474	6	1	8	300	41.29
280-100475	8	1	4	300	60.64
280-100476	10	1	2	300	74.89
280-100477	12	1	2	300	122.73
280-100478	15	1	0	300	197.60
280-100479	18	1	0	300	349.95
280-100480	20	1	0	300	388.73

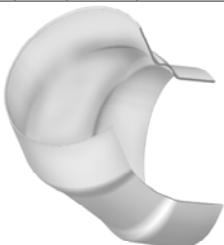

**45° Elbow**

**Socket x Socket**

280-100592	6	1	4	300	41.29
280-100593	8	1	4	300	60.64
280-100594	10	1	2	300	74.89
280-100595	12	1	2	300	122.73
280-100596	15	1	0	300	197.60
280-100597	18	1	0	300	349.95
280-100598	20	1	0	300	388.73

Part Number	Size	Std Pk	Mstr Ctn	Prod Code	MSRP
-------------	------	--------	----------	-----------	------

**60° Elbow**

**Socket x Socket**

280-100702	6	1	4	300	77.48
280-100703	8	1	2	300	95.53
280-100704	10	1	0	300	152.41
280-100705	12	1	0	300	200.16
280-100706	15	1	0	300	326.72
280-100707	18	1	0	300	565.64
280-100708	20	1	0	300	762.03

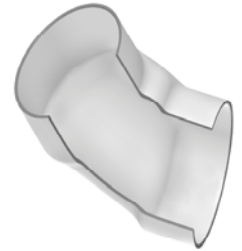

**Couplings**

**Coupling**

**Socket x Socket**

280-100001	4 IPS	1	10	300	16.73
280-100002	6	1	5	300	20.64
280-100003	8	1	6	300	23.23
280-100004	10	1	4	300	32.29
280-100005	12	1	4	300	43.93
280-100006	15	1	0	300	77.48
280-100007	18	1	0	300	138.15
280-100008	20	1	0	300	170.45



**Reducer Coupling**

**Coupling - Reducer**

**Socket x Socket**

280-100928	8X6	1	2	300	36.16
2829-626	10X6	1	8	300	145.66
280-100931	10X8	1	4	300	55.54
280-100933	12X6	1	6	300	207.71
280-100934	12X8	1	4	300	161.43
280-100935	12X10	1	4	300	80.09
2829-726	15X6	1	0	300	360.45
2829-728	15X8	1	0	309	258.89
280-100939	15X10	1	0	300	184.07
280-100940	15X12	1	0	300	121.35

