



Fabricated Fittings Technical

**PVC Low Head PIP Fabricated Fittings, Risers & Accessories**

# **PVC Low Head PIP Fabricated Fittings, Risers & Accessories**



## **ENGINEERING GUIDE**

Contact Spears® for any Information not found.

Fabricated Fittings Technical  
**PVC Low Head PIP Fabricated Fittings, Risers & Accessories**



### Low Head PIP Tee

Socket x Socket x Socket

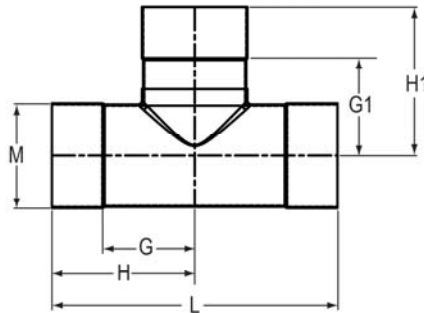

Part Number	Size	G	G1	H	H1	L	M	Approx. Wt. (Lbs.)
<a href="#">280-102502</a>	6	5-1/2	5-7/8	8-1/2	8-7/8	17	6-1/4	1.87
<a href="#">280-102507</a>	8	6-9/16	6-13/16	10-9/16	10-13/16	21-1/8	8-5/16	3.43
<a href="#">280-102513</a>	10	7-9/16	8-13/16	12-9/16	13-13/16	25-1/8	10-7/16	7.02
<a href="#">280-102520</a>	12	8-11/16	9-13/16	13-11/16	14-13/16	27-3/8	12-1/2	10.39
<a href="#">280-102528</a>	15	11-15/16	12-5/16	16-15/16	17-5/16	33-7/8	15-5/8	17.00
<a href="#">280-102537</a>	18	13-9/16	13-13/16	19-9/16	19-13/16	39-1/18	18-3/4	29.27
<a href="#">280-102547</a>	20	15	15-13/16	21-1/2	21-13/16	43	20-13/16	38.85

### Low Head PIP 90° Elbow

Socket x Socket

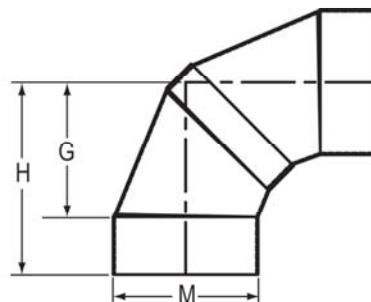

Part Number	Size	G	H	M	Approx. Wt. (Lbs.)
<a href="#">280-100812</a>	6	5-13/16	8-5/16	6-1/4	1.34
<a href="#">280-100813</a>	8	7-3/16	10-3/16	8-5/16	2.40
<a href="#">280-100814</a>	10	9-1/4	13-1/4	10-7/16	4.84
<a href="#">280-100815</a>	12	10-5/16	15-5/16	12-1/2	7.75
<a href="#">280-100816</a>	15	13-1/2	18-1/2	15-5/8	14.09
<a href="#">280-100817</a>	18	16-1/16	22-1/16	18-3/4	24.77
<a href="#">280-100818</a>	20	18-3/16	24-3/16	20-13/16	29.86



**Low Head PIP 11-1/4° Elbow**

Socket x Socket

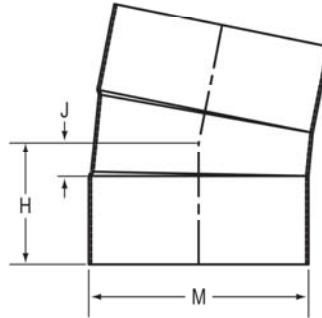

Part Number	Size	H	J	M	Approx. Wt. (Lbs.)
280-100114	6	3-7/16	15/16	6-1/4	.61
280-100115	8	4-1/16	1-1/16	8-5/16	1.16
280-100116	10	5-3/8	1-3/8	10-7/16	2.37
280-100117	12	6-1/2	1-1/2	12-1/2	3.72
280-100118	15	7-1/4	2-1/4	15-5/8	6.21
280-100119	18	8-11/16	2-11/16	18-3/4	10.04
280-100120	20	9-1/16	3-1/16	20-13/16	13.19

**Low Head PIP 15° Elbow**

Socket x Socket

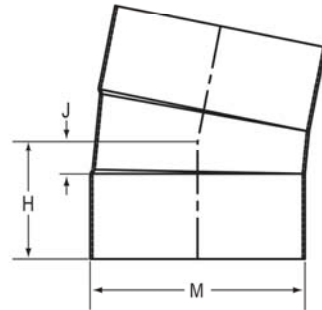

Part Number	Size	H	J	M	Approx. Wt. (Lbs.)
280-100234	6	3-9/16	1-1/16	6-1/4	.74
280-100235	8	4-3/16	1-3/16	8-5/16	1.10
280-100236	10	5-9/16	1-9/16	10-7/16	2.35
280-100237	12	6-11/16	1-11/16	12-1/2	3.87
280-100238	15	7-9/16	2-9/16	15-5/8	6.01
280-100239	18	9	3	18-3/4	11.22
280-100240	20	9-3/8	3-3/8	20-13/16	13.61

Fabricated Fittings Technical  
**PVC Low Head PIP Fabricated Fittings, Risers & Accessories**



**Low Head PIP 22-1/2° Elbow**

Socket x Socket

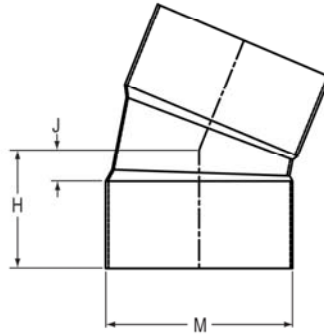

Part Number	Size	H	J	M	Approx. Wt. (Lbs.)
<a href="#">280-100354</a>	6	3-3/4	1-1/4	6-1/4	.66
<a href="#">280-100355</a>	8	4-7/16	1-7/16	8-5/16	1.21
<a href="#">280-100356</a>	10	5-15/16	1-15/16	10-7/16	2.42
<a href="#">280-100357</a>	12	7-1/8	2-1/8	12-1/2	3.74
<a href="#">280-100358</a>	15	8-1/16	3-1/16	15-5/8	6.76
<a href="#">280-100359</a>	18	9-5/8	3-5/8	18-3/4	12.18
<a href="#">280-100360</a>	20	10-1/8	4-1/8	20-12/16	15.85

**Low Head PIP 30° Elbow**

Socket x Socket

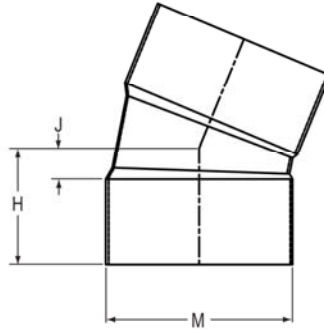

Part Number	Size	H	J	M	Approx. Wt. (Lbs.)
<a href="#">280-100474</a>	6	4	1-1/2	6-1/4	.63
<a href="#">280-100475</a>	8	4-3/4	1-3/4	8-5/16	1.25
<a href="#">280-100476</a>	10	6-5/16	2-5/16	10-7/16	2.77
<a href="#">280-100477</a>	12	7-9/16	2-9/16	12-1/2	3.78
<a href="#">280-100478</a>	15	8-5/8	3-5/8	15-5/8	7.22
<a href="#">280-100479</a>	18	10-5/16	4-5/16	18-3/4	11.03
<a href="#">280-100480</a>	20	10-7/8	4-7/8	20-13/16	15.52



**Low Head PIP 45° Elbow**

Socket x Socket

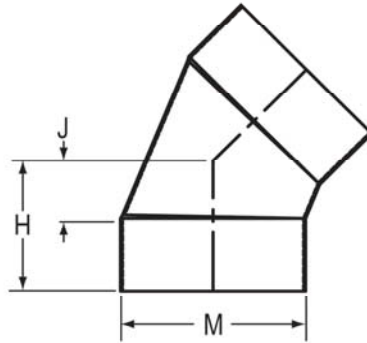

Part Number	Size	H	J	M	Approx. Wt. (Lbs.)
<a href="#">280-100592</a>	6	4-1/2	2	6-1/4	.72
<a href="#">280-100593</a>	8	5-3/8	2-3/8	8-5/16	1.32
<a href="#">280-100594</a>	10	7-1/8	3-1/8	10-7/16	2.88
<a href="#">280-100595</a>	12	8-9/16	3-9/16	12-1/2	4.58
<a href="#">280-100596</a>	15	9-7/8	4-7/8	15-5/8	8.03
<a href="#">280-100597</a>	18	11-3/4	5-3/4	18-3/4	12.77
<a href="#">280-100598</a>	20	12-1/2	6-1/2	20-13/16	17.73

**Low Head PIP 60° Elbow**

Socket x Socket

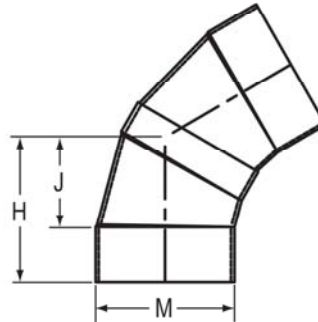

Part Number	Size	H	J	M	Approx. Wt. (Lbs.)
<a href="#">280-100702</a>	6	6-9/16	4-1/16	6-1/4	2.15
<a href="#">280-100703</a>	8	7-15/16	4-15/16	8-5/16	2.15
<a href="#">280-100704</a>	10	10-3/8	6-3/8	10-7/16	4.33
<a href="#">280-100705</a>	12	12	7	12-1/2	7.33
<a href="#">280-100706</a>	15	14-5/16	9-5/16	15-5/8	12.92
<a href="#">280-100707</a>	18	17-1/16	11-1/16	18-3/4	19.47
<a href="#">280-100708</a>	20	18-9/16	12-9/16	20-13/16	45.57



## Low Head PIP Coupling

Socket x Socket

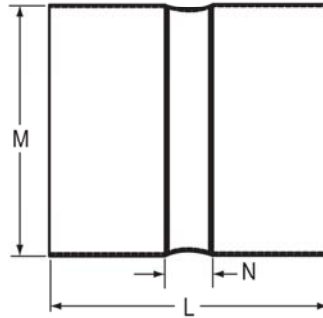

Part Number	Size	L	M	N	Approx. Wt. (Lbs.)
<a href="#">280-100001</a>	4 IPS	5-5/8	4-3/4	1-1/8	.48
<a href="#">280-100002</a>	6	6-5/8	6-3/8	5/8	.66
<a href="#">280-100003</a>	8	9	8-3/8	1	1.12
<a href="#">280-100004</a>	10	11-1/2	10-7/16	1-1/2	2.40
<a href="#">280-100005</a>	12	11-1/2	12-1/2	1-1/2	3.25
<a href="#">280-100006</a>	15	11-3/4	15-5/8	1-3/4	5.15
<a href="#">280-100007</a>	18	13-5/8	18-3/4	1-5/8	8.63
<a href="#">280-100008</a>	20	15-1/2	20-13/16	2-1/2	11.32

## Low Head PIP End Cap

Socket

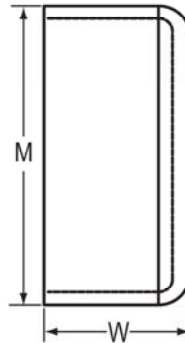

Part Number	Size	M	W	Approx. Wt. (Lbs.)
<a href="#">280-107539</a>	4 IPS	4-7/8	2-1/4	.35
<a href="#">280-107540</a>	6	6-7/16	2-1/2	.52
<a href="#">280-107541</a>	8	8-7/16	3-1/4	.88
<a href="#">280-107542</a>	10	10-9/16	3-3/8	1.65
<a href="#">280-107543</a>	12	12-5/8	4	2.62
<a href="#">280-107545</a>	15	15-11/16	4-3/4	3.96
<a href="#">280-107547</a>	18	18-3/4	3-5/16	4.64
<a href="#">280-107548</a>	20	20-3/4	2-3/4	4.22



**Low Head PIP Cross**

Socket x Socket x Socket x Socket

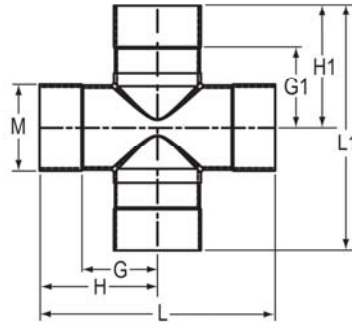

Part Number	Size	G	G1	H	H1	L	L1	M	Approx. Wt. (Lbs.)
<a href="#">280-103286</a>	6	5-1/2	5-7/8	8-1/2	8-7/8	17	17-3/4	6-1/4	2.24
<a href="#">280-103291</a>	8	6-9/16	6-13/16	10-9/16	10-13/16	21-1/8	21-5/8	8-5/16	4.07
<a href="#">280-103297</a>	10	7-9/16	8-13/16	12-9/16	13-13/16	25-1/8	27-5/8	10-7/16	8.32
<a href="#">280-103304</a>	12	8-11/16	9-13/16	13-11/16	14-13/16	27-3/8	29-5/8	12-1/2	12.33
<a href="#">280-103321</a>	15	11-15/16	12-5/16	16-15/16	17-5/16	33-7/8	34-5/8	15-5/8	20.79
<a href="#">280-103342</a>	18	13-9/16	13-13/16	19-9/16	19-13/16	39-1/8	39-5/8	18-3/4	34.36
<a href="#">280-103354</a>	20	15	15-13/16	21-1/2	21-13/16	43	43-5/8	20-13/16	47.24

**Low Head PIP Wye**

Socket x Socket x Socket

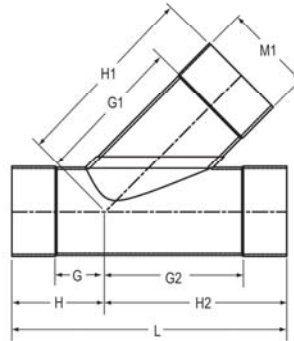

Part Number	Size	G	G1	G2	H	H1	H2	L	M	M1	Approx. Wt. (Lbs.)
<a href="#">2875-060</a>	6	3-11/16	10-15/16	9-13/16	6-11/16	13-15/16	12-13/16	19-1/2	6-1/4	6-1/4	2.42
<a href="#">2875-080</a>	8	4-5/8	13-13/16	12-3/4	8-5/8	17-13/16	16-3/4	25-3/8	8-5/16	8-5/16	4.95
<a href="#">2875-100</a>	10	5-11/16	16-3/4	15-15/16	10-11/16	21-3/4	20-15/16	31-5/8	10-7/16	10-7/16	8.75
<a href="#">2875-120</a>	12	6-11/16	19-1/8	18-15/16	11-11/16	24-1/8	23-15/16	35-5/8	12-1/2	12-1/2	14.00
<a href="#">2875-150</a>	15	8-7/16	23-9/16	23-11/16	13-7/16	28-9/16	28-11/16	42-1/8	15-5/8	15-5/8	25.44
<a href="#">2875-183</a>	18	7-3/16	25-9/16	25-9/16	13-3/16	31-9/16	31-9/16	44-3/4	18-3/4	18-3/4	39.97
<a href="#">2875-200</a>	20	9-5/8	30	30	16-1/8	36-1/2	36-1/2	52-5/8	20-13/16	20-13/16	55.48

**Fabricated Fittings Technical**  
**PVC Low Head PIP Fabricated Fittings, Risers & Accessories**



**Low Head PIP Double Wye**

Socket x Socket x Socket x Socket

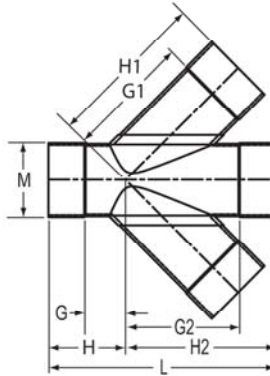

Part Number	Size	G	G1	G2	H	H1	H2	L	M	Approx. Wt. (Lbs.)
<a href="#">2876-060</a>	6	3-11/16	10-15/16	9-13/16	6-11/16	13-15/16	12-13/16	19-1/2	6-1/4	3.19
<a href="#">2876-080</a>	8	4-5/8	13-13/16	12-3/4	8-5/8	17-13/16	16-3/4	25-3/8	8-5/16	5.74
<a href="#">2876-100</a>	10	5-11/16	16-3/4	15-15/16	10-11/16	21-3/4	20-15/16	31-5/8	10-7/16	11.51
<a href="#">2876-120</a>	12	6-11/16	19-1/8	18-15/16	11-11/16	24-1/8	23-15/16	35-5/8	12-9/16	15.58
<a href="#">2876-150</a>	15	8-7/16	23-9/16	23-11/16	13-7/16	28-9/16	28-11/16	42-1/8	15-5/8	34.21
<a href="#">2876-183</a>	18	7-3/16	25-9/16	25-9/16	13-3/16	31-9/16	31-9/16	44-3/4	18-3/4	47.99
<a href="#">2876-200</a>	20	9-5/8	30	30	16-1/8	36-1/2	36-1/2	52-5/8	20-13/16	75.66

**Low Head IPS x PIP Adapter**

Socket x Socket

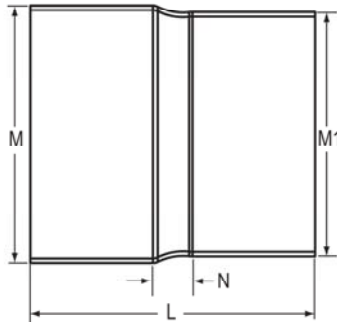

Part Number	Size	L	M	M1	N	Approx. Wt. (Lbs.)
<a href="#">280-101649</a>	6	7-7/8	6-7/8	6-3/8	1-3/8	.99
<a href="#">280-101650</a>	8	9-7/8	8-15/16	8-1/2	1-3/8	2.26
<a href="#">280-101651</a>	10	12-1/4	11-1/8	10-5/8	1-3/4	4.38
<a href="#">280-101652</a>	12	11-13/16	13-1/4	12-3/4	1-13/16	6.05





**Low Head PIP Concrete Adapter**

Socket x Concrete

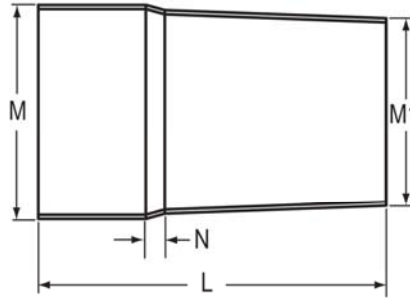

Part Number	Size	L	M	M1	N	Approx. Wt. (Lbs.)
280-101761	6X6	8-1/2	6-3/8	5-9/16	1/2	1.14
280-101762	8X8	13-3/4	8-1/2	7-7/16	3/4	3.12
280-101763	10X10	16-13/16	10-5/8	9-1/2	15/16	4.82
280-101764	12X12	18	12-3/4	11-1/2	5/8	7.44
280-101765	12X14	16	12-3/4	13-9/16	3-1/8	8.98
280-101766	15X14	14-3/8	15-15/16	12-5/8	1-1/2	10.55
280-101767	15X15	14-1/4	15-5/8	14-1/4	1-1/8	6.07
280-101768	15X16	17	15-7/8	15-1/2	3-3/4	13.52
280-101769	18X18	18-3/4	18-3/4	17-3/16	1/2	11.85
280-101770	20X20	17-1/2	20-13/16	19-1/2	1-1/2	14.31

**Low Head PIP Linegate Valve Adapter**

Socket x Linegate

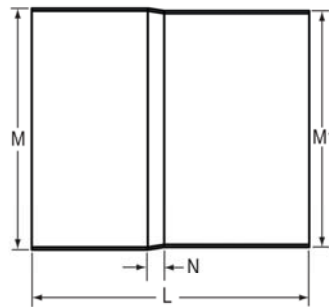

Part Number	Size	L	M	M1	N	Approx. Wt. (Lbs.)
280-101777	6	7-5/8	6-1/4	6-1/8	5/8	.71
280-101778	8	9-9/16	8-5/16	8-3/16	9/16	1.05
280-101779	10	10-9/16	10-7/16	10-3/16	9/16	1.85
280-101780	12	10-9/16	12-1/2	12-1/4	9/16	2.75
280-101781	15	11-1/16	15-5/8	15-5/16	13/16	4.16
2845-180	18	11-13/16	18-3/4	18-3/8	13/16	7.31
2845-180P	18	15-1/4	19-1/8	18-3/8	1-1/4	9.35



## Low Head PIP Mechanical Vent Riser

Saddle x Riser/Vent x Chamber

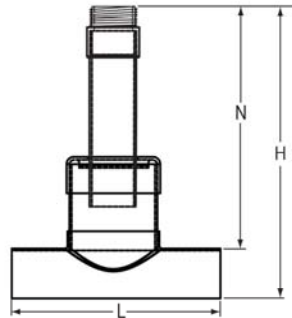

Part Number	Size	H	L	N	Approx. Wt. (Lbs.)
<a href="#">2883-52842</a>	6X2X4	45-3/16	12	42	4.10
<a href="#">2883-57842</a>	8X2X6	46-3/16	10-3/4	42	4.38
<a href="#">2883-58042</a>	8X3X6	46-3/16	10-3/4	42	7.06
<a href="#">2883-62142</a>	10X2X8	47-1/4	14	42	5.30
<a href="#">2883-62342</a>	10X3X8	47-1/4	14	42	8.32
<a href="#">2883-62442</a>	10X4X8	47-1/4	14	42	6.83
<a href="#">2883-66142</a>	12X2X10	48-1/4	17	42	7.84
<a href="#">2883-66342</a>	12X3X10	48-1/4	17	42	9.95
<a href="#">2883-66442</a>	12X4X10	48-1/4	17	42	9.11
<a href="#">2883-72442</a>	15X4X12	49-15/16	26	42	12.97
<a href="#">2883-78442</a>	18X4X15	51-3/8	25	42	20.87
<a href="#">2883-81442</a>	20X4X18	52-7/16	29-1/2	42	28.62

## Low Head PIP Vent Base

Saddle x Riser x Outlet

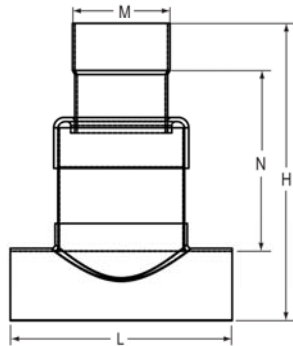

Part Number	Size	H	L	M	N	Approx. Wt. (Lbs.)
<a href="#">2888-532020</a>	6X4X2	10-11/16	12	2-11/16	5-7/8	1.70
<a href="#">2888-585030</a>	8X6X3	14-13/16	10-3/4	3-15/16	8-1/2	2.40
<a href="#">2888-585040</a>	8X6X4	15-1/8	10-3/4	4-3/4	8-13/16	2.35
<a href="#">2888-628060</a>	10X8X6	18-5/16	14	6-1/4	10-13/16	3.35
<a href="#">2888-670060</a>	12X10X6	21-1/8	17	6-1/4	12	5.86
<a href="#">2888-732080</a>	15X12X8	25-7/16	19	8-5/16	13-13/16	9.97
<a href="#">2888-795080</a>	18X15X8	30	25	8-5/16	16-13/16	17.62



**Low Head PIP Vent Base**

(Continued)

Saddle x Riser x Outlet

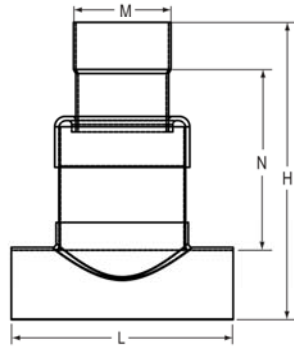

Part Number	Size	H	L	M	N	Approx. Wt. (Lbs.)
2888-828080	20X18X8	34-1/8	29-1/2	8-5/16	19-15/16	25.88

Fabricated Fittings Technical  
**Glue-On Saddles**



**Low Head PIP Same Size Saddle**

Socket

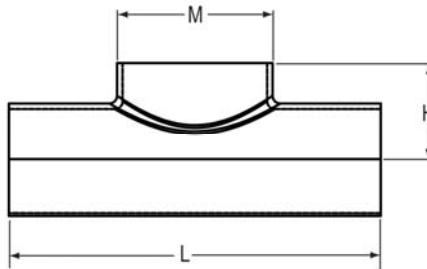

Part Number	Size	H	L	M	Approx. Wt. (Lbs.)
<a href="#">280-101937</a>	6X6	4-1/4	13	6-1/4	.81
<a href="#">280-101938</a>	8X8	5-9/16	16	8-5/16	1.51
<a href="#">280-101939</a>	10X10	6-15/16	19	10-7/16	2.75
<a href="#">280-101940</a>	12X12	8-1/8	22	12-1/2	4.09
<a href="#">280-101941</a>	15X15	9-11/16	27	15-5/8	8.30
<a href="#">280-101942</a>	18X18	11-3/8	32	18-3/4	13.81
<a href="#">280-101943</a>	20X20	12-11/16	38	20-13/16	20.94

**Low Head PIP Same Size Stub Saddle**

Socket

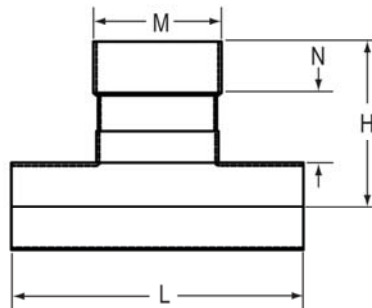

Part Number	Size	H	L	M	N	Approx. Wt. (Lbs.)
<a href="#">280-101949</a>	6X6	8-15/16	13	6-1/4	2-7/8	1.40
<a href="#">280-101950</a>	8X8	10-7/8	16	8-5/16	2-13/16	2.37
<a href="#">280-101951</a>	10X10	13-15/16	19	10-7/16	3-13/16	4.47
<a href="#">280-101952</a>	12X12	14-15/16	22	12-7/16	3-13/16	7.04
<a href="#">280-101953</a>	15X15	17-7/16	27	15-5/8	4-13/16	12.46
<a href="#">280-101954</a>	18X18	20	32	18-3/4	4-13/16	20.85
<a href="#">280-101955</a>	20X20	21-15/16	38	20-13/16	11-3/4	28.94